

UP TO 12'-2" WIDE X 18'-0" HIGH (MAX. SIZE)

PAGE 1 OF 1

REVISIONS

| REV. NO. | ZONE: | DATE:   | ECN NO. | APPVD: | DESCRIPTION                       |
|----------|-------|---------|---------|--------|-----------------------------------|
| 08       | --    | 12/2011 | --      | --     | REVISED WIND SPEEDS PER ASCE7-10. |

MODELS AVAILABLE

CLOPAY MODEL 3200 (24 GA MIN EXT SKIN WITH MINOR RIBS).  
 CLOPAY MODEL 3205 (24 GA MIN EXT SKIN FLUSH).  
 CLOPAY MODEL 3220 (20 GA MIN EXT SKIN WITH MINOR RIBS).  
 HOLMES MODEL 240, 240G (24 GA MIN EXT SKIN WITH MINOR RIBS).

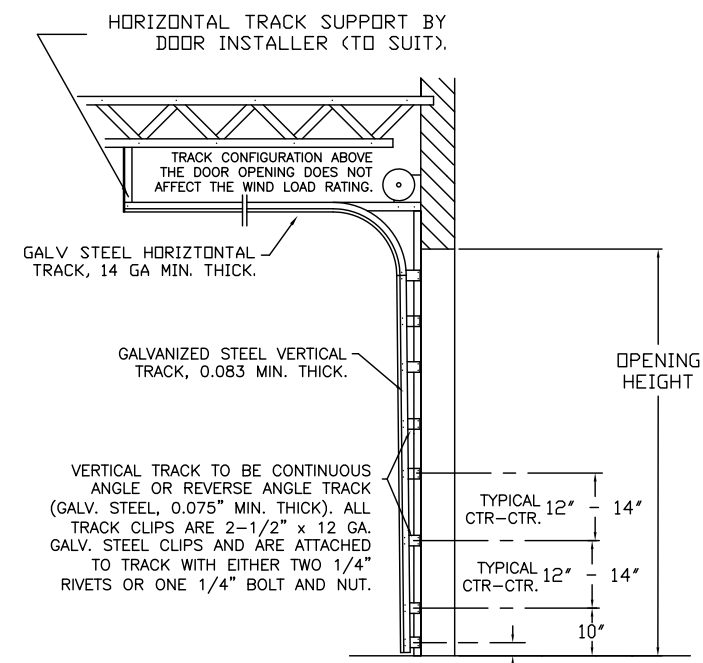

STANDARD-LIFT TRACK DETAILS

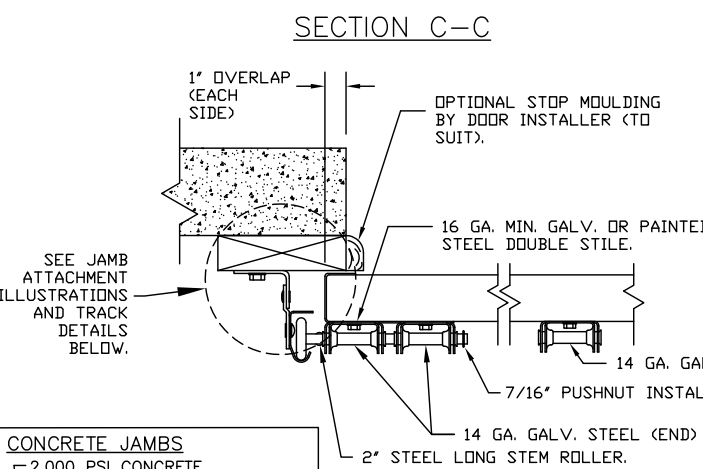

SECTION C-C

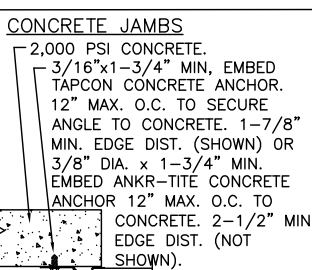

CONCRETE JAMBS  
 2,000 PSI CONCRETE.  
 3/16"x1-3/4" MIN. EMBED TAPCON CONCRETE ANCHOR. 12" MAX. O.C. TO SECURE ANGLE TO CONCRETE. 1-7/8" MIN. EDGE DIST. (SHOWN) OR 3/8" DIA. x 1-3/4" MIN. EMBED ANKR-TITE CONCRETE ANCHOR 12" MAX. O.C. TO CONCRETE. 2-1/2" MIN. EDGE DIST. (NOT SHOWN).

ANCHOR NOTE: FIRST (BOTTOM) ANCHOR SHALL BE INSTALLED AT NO MORE THAN HALF OF THE MAXIMUM ON-CENTER DISTANCE. HIGHEST ANCHOR SHALL BE INSTALLED AT LEAST AS HIGH AS THE DOOR OPENING. HORIZONTAL JAMBS DO NOT TRANSFER LOAD.

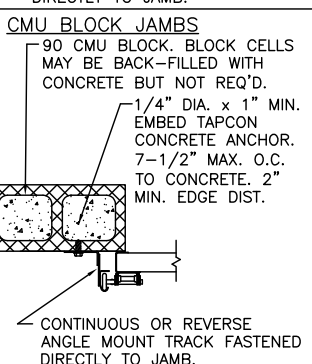

CMU BLOCK JAMBS  
 90 CMU BLOCK. BLOCK CELLS MAY BE BACK-FILLED WITH CONCRETE BUT NOT REQ'D.  
 1/4" DIA. x 1" MIN. EMBED TAPCON CONCRETE ANCHOR. 7-1/2" MAX. O.C. TO CONCRETE. 2" MIN. EDGE DIST.

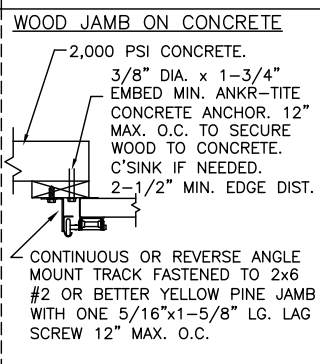

WOOD JAMB ON CONCRETE  
 2,000 PSI CONCRETE.  
 3/8" DIA. x 1-3/4" EMBED MIN. ANKR-TITE CONCRETE ANCHOR. 12" MAX. O.C. TO SECURE WOOD TO CONCRETE. C'SINK IF NEEDED.  
 2-1/2" MIN. EDGE DIST.

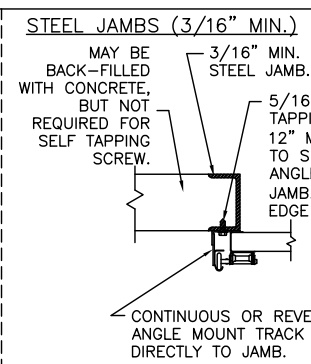

STEEL JAMBS (3/16" MIN.)  
 MAY BE BACK-FILLED WITH CONCRETE, BUT NOT REQUIRED FOR SELF TAPPING SCREW.  
 3/16" MIN. STEEL JAMB.  
 5/16"x1" SELF TAPPING SCREW. 12" MAX. O.C. TO SECURE ANGLE TO STEEL JAMB. 1/2" MIN. EDGE DIST.

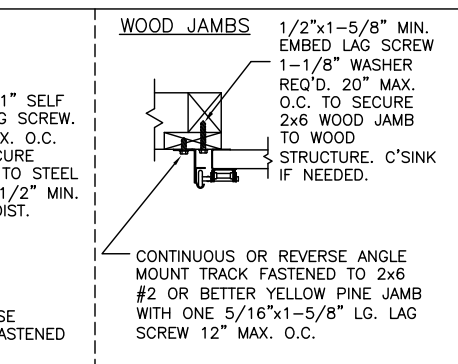

WOOD JAMBS  
 1/2"x1-5/8" MIN. EMBED LAG SCREW 1-1/8" WASHER REQ'D. 20" MAX. O.C. TO SECURE 2x6 WOOD JAMB TO WOOD STRUCTURE. C'SINK IF NEEDED.

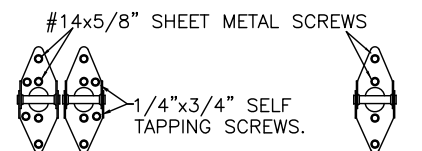

VIEW "A"  
 14 GA. DOUBLE END HINGES ATTACH ON EACH HINGE AS SHOWN (4) #14 X 5/8" LG. SHT. MTL. SCREWS AND (2) 1/4"x3/4" SELF-TAPPING SCREWS.

VIEW "B"  
 14 GA. INTERMEDIATE HINGE ATTACH ON EACH HINGE AS SHOWN WITH (4) 1/4" X 5/8" SHEET METAL SCREWS.

SECTION B-B (IMPACT-RESISTANT GLAZING OPTION)

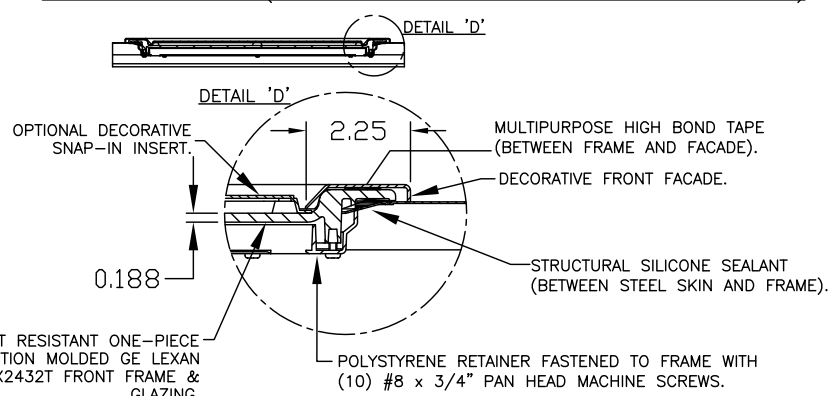

THIS DOOR MEETS THE REQUIREMENTS OF THE LARGE MISSILE IMPACT AND CYCLIC TESTING.

THIS DOOR MEETS OR EXCEEDS THE DESIGN LOADS FOR THE ULTIMATE WIND SPEEDS LISTED BELOW ACCORDING TO THE FLORIDA BUILDING CODE OR THE INTERNATIONAL BUILDING CODE (BASED ON ASCE7-10) FOR THE FOLLOWING CONDITIONS: 1) ENCLOSED BUILDING, 2) DOOR HAS 2' OF WIDTH IN BUILDING'S END ZONE, 3) ANY ROOF SLOPE, AND 4) TESTING IN ACCORDANCE WITH ANSI/DASMA 108 AND ANSI/DASMA 115. SITE-SPECIFIC CALCULATIONS BY A QUALIFIED DESIGN PROFESSIONAL MAY DIFFER.

| ULTIMATE WIND SPEED (MPH) | 210 | 210 | 195 | 190 | 180 |
|---------------------------|-----|-----|-----|-----|-----|
| EXPOSURE LEVEL            | B   | C   | C   | D   | D   |
| MEAN ROOF HEIGHT          | 30' | 15' | 30' | 15' | 30' |

| DOOR HEIGHT 'A'    | NUMBER OF SECTIONS |
|--------------------|--------------------|
| 8'-0"              | 4                  |
| 8'-3" THRU 10'-0"  | 5                  |
| 10'-3" THRU 12'-0" | 6                  |
| 12'-3" THRU 14'-0" | 7                  |
| 14'-3" THRU 16'-0" | 8                  |
| 16'-3" THRU 18'-0" | 9                  |

NOTES:  
 1. A 1/3 STRESS INCREASE FOR WIND LOAD WAS NOT USED IN THE CALCULATION OF ALLOWABLE LOADS FOR ANCHORS AND FASTENERS FOR STEEL, CONCRETE AND MASONRY.  
 2. THE PRODUCT, INSTALLED IN COMPLIANCE WITH THE CONDITIONS SHOWN ON THIS DRAWING, COMPLIES WITH THE 2007 FLORIDA BUILDING CODE.

ATTENTION: THE DESIGN OF THE SUPPORTING STRUCTURAL ELEMENTS ARE THE RESPONSIBILITY OF THE PROFESSIONAL OF RECORD FOR THE BUILDING OR STRUCTURE AND IN ACCORDANCE WITH CURRENT BUILDING CODES FOR THE LOADS LISTED ON THIS DRAWING.

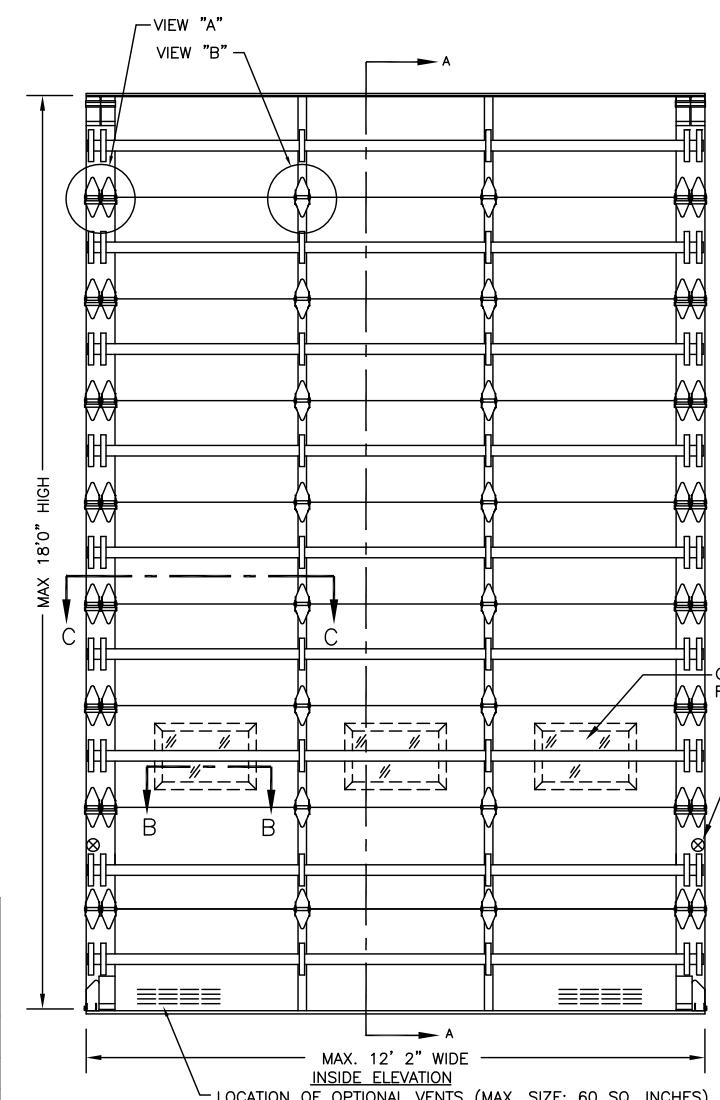

SECTION A-A

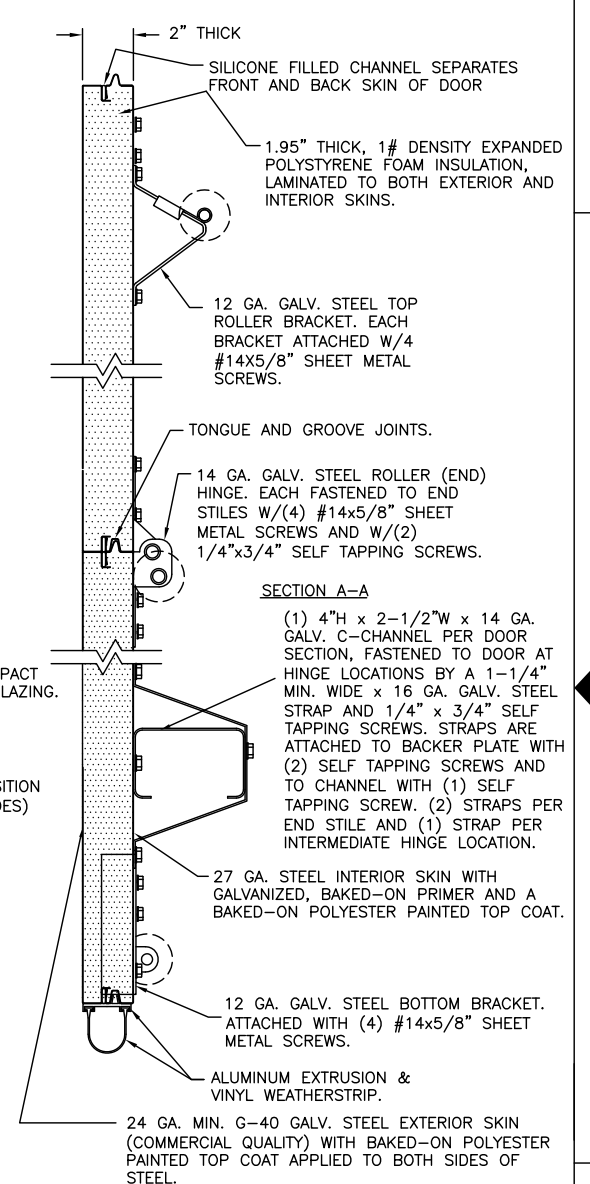

DESIGN LOADS: +52.0 P.S.F. & -58.0 P.S.F.  
 TEST LOADS: +78.0 P.S.F. & -87.0 P.S.F.

DESIGN ENGINEER:  
 SCOTT HAMILTON  
 FLORIDA P.E. #63286

Unless Stated Otherwise TOLERANCES are  
 .0 = ±.031  
 .00 = ±.015  
 .000 = ±.005  
 .0000 = ±.001  
 Degrees = ±1/2"

Unless Stated Otherwise DIMENSIONS ARE IN INCHES.

**Glopay**  
 Building Products Company  
 8585 Duke Boulevard  
 Mason, OH 45040 USA  
 Tel. No. 513-770-4800  
 Fax No. 513-770-4853

MANUFACTURING PRODUCT CODE:  
 MPC: C-DSIE-1F447

PART NO.: N/A

WINDLOAD RATING  
 W8

|   |                |              |
|---|----------------|--------------|
| DESCRIPTION: COMMERCIAL EPS DOOR, +52/-58 PSF DESIGN LOAD | SCALE: NTS     | DWG. SIZE B  |
| DRAWN BY: RJK   | DATE: 11/13/02 | SHEET 1 OF 1 |
| CHECKED BY: MWW   | DATE: 11/02    | VER: IBC     |
| DWG. NO.: 101705  |                |              |