

# MODEL 902, 903, C2AL, C3AL MAX 16'-2" WIDE X 18' HIGH

902 AND C2AL HAVE STILES ON 44" OC SPACINT; 903 AND C3AL HAVE EQUAL-WIDTH PANELS.

REV	DATE	DESCRIPTION
01	7/2005	UPDATED CODE REF.
02	10/2005	ADDED ROLLER OPTION
03	11/2008	ADDED MFC, UPDATED JAMB ATTACHMENT.
04	1/2011	ADDED 903 AND C3AL
05	02/2012	UPDATED WINDLOAD CHART

MODEL IS MADE OF 6063-T5 ALUMINUM EXTRUSIONS.  
WALL THICKNESS:  
TOP & BOTTOM RAILS .075  
INTER. TOP & BOTTOM RAILS .075  
TOP HAS .1 x 1.875" FIN  
INTER. TOP RAIL CAP .040  
SINGLE & DOUBLE END STILES .075  
CENTER STILES .062

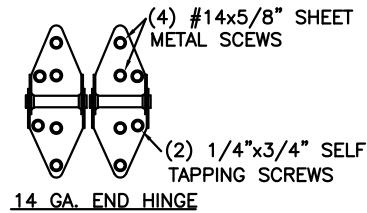

FULL-VISION SECTIONS TO BE OF 1/8" DSB GLASS OR 1/8" ACRYLIC OR BETTER, HELD IN PLACE WITH SNAP-IN GLAZING BEAD AND ADHESIVE.  
OPTIONAL ACRYLIC GLAZING IS PLASKOLITE OPTIX, AN APPROVED CLASS CC2 PLASTIC IN COMPLIANCE WITH FBC 2604 / IBC 2606.

THE DESIGN OF THE SUPPORTING STRUCTURAL ELEMENTS IS THE RESPONSIBILITY OF THE BUILDING ENGINEER OR ARCHITECT OF RECORD.

NOTE: DOUBLE TRACK LOW HEADROOM, HI-LIFT TRACK, FOLLOW-THE-ROOF TRACK, AND VERTICAL LIFT TRACK ARE AVAILABLE OPTIONS. 3" TRACK ALSO AVAILABLE.

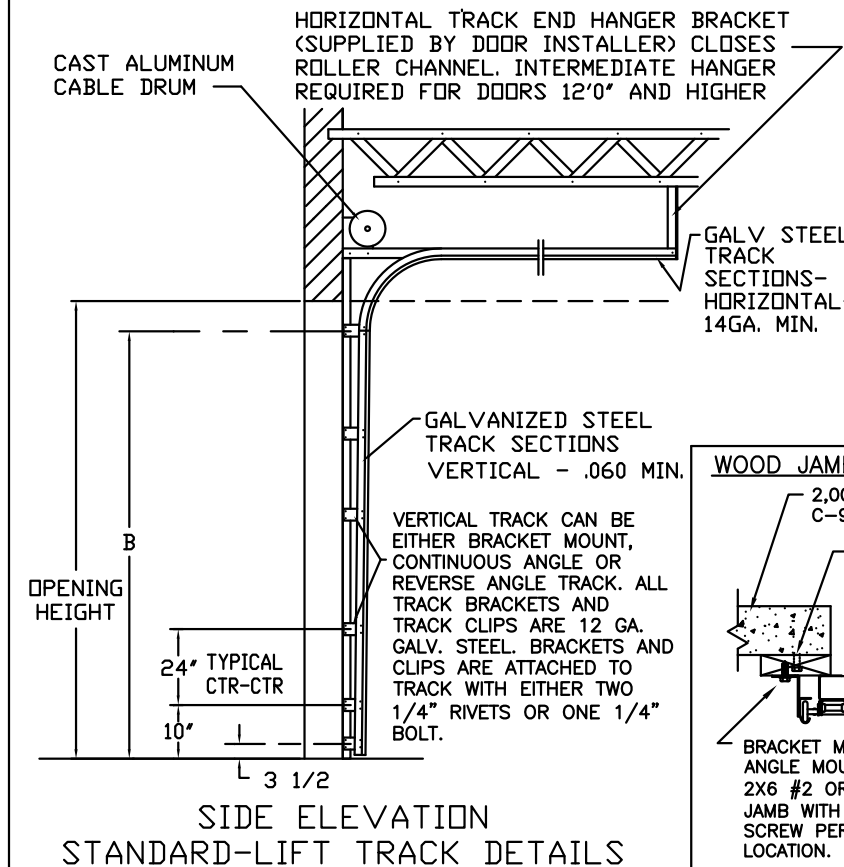

### SECTION 1 - 1

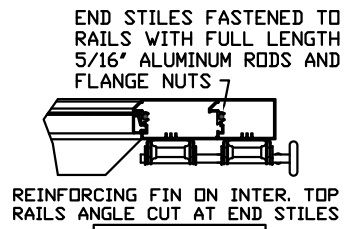
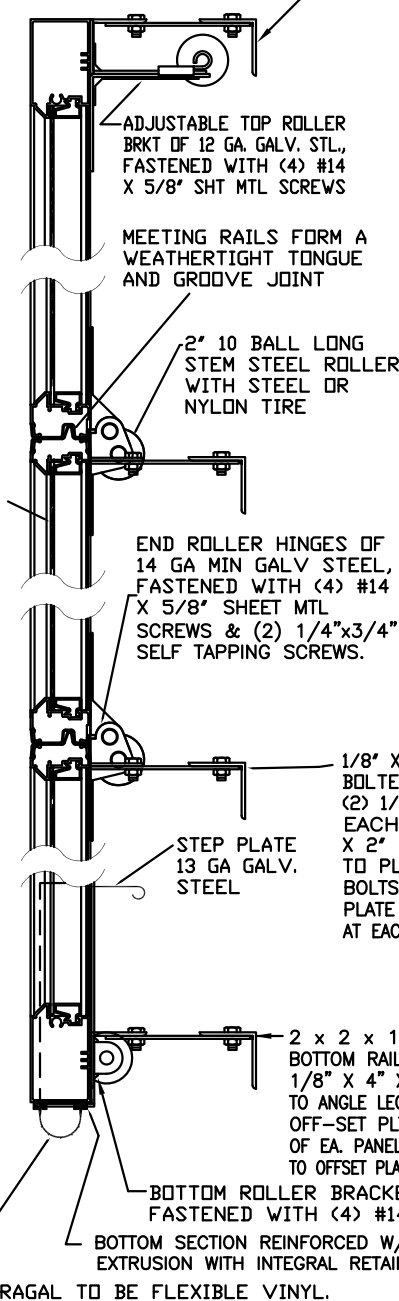

### SECTION 4 - 4

HEIGHT 'A'	NO. OF SECTIONS
UP TO 8-0	4
8-3 THRU 10-0	5
10-3 THRU 12-0	6
12-3 THRU 14-0	7
14-3 THRU 16-0	8
16-3 THRU 18-0	9

CENTER STILES FASTENED TO RAILS WITH FULL LENGTH 5/16" ALUMINUM RODS AND FLANGE NUTS

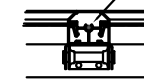

### SECTION 2 - 2

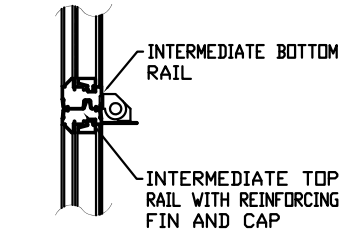

### SECTION 3 - 3

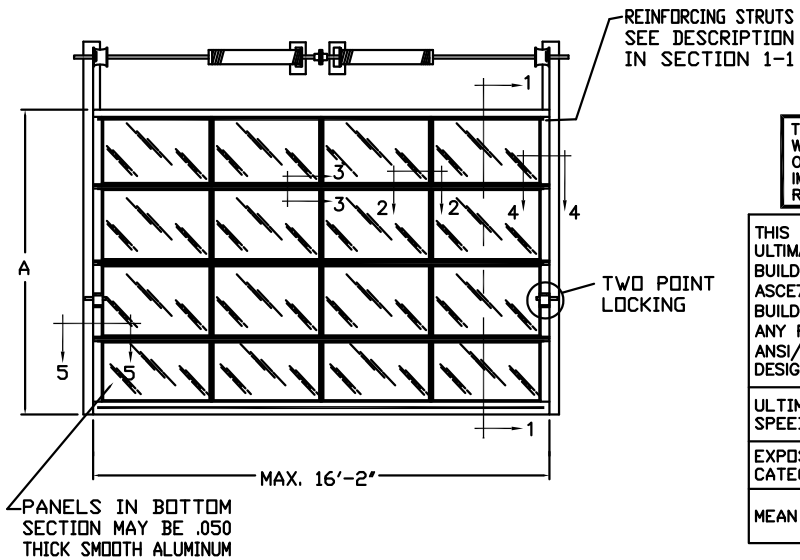

THE OPTIONAL GLAZING SHOWN ON THIS DRAWING MEETS THE WIND LOAD REQUIREMENTS OF THE FLORIDA BUILDING CODE OR INTERNATIONAL BUILDING CODE BUT DOES NOT MEET THE IMPACT RESISTANT REQUIREMENT FOR WINDBORNE DEBRIS REGIONS (REFER TO CHAPTER 16 FBC / IBC).

THIS DOOR MEETS OR EXCEEDS THE DESIGN LOADS FOR THE ULTIMATE WIND SPEEDS LISTED BELOW ACCORDING TO THE FLORIDA BUILDING CODE OR THE INTERNATIONAL BUILDING CODE (BASED ON ASCE7-10) FOR THE FOLLOWING CONDITIONS: 1) ENCLOSED BUILDING, 2) DOOR HAS 2' OF WIDTH IN BUILDING'S END ZONE, 3) ANY ROOF SLOPE, AND 4) TESTING IN ACCORDANCE WITH ANSI/DASMA 108. SITE-SPECIFIC CALCULATIONS BY A QUALIFIED DESIGN PROFESSIONAL MAY DIFFER.

ULTIMATE WIND SPEED (MPH)	135	140	150	155	170
EXPOSURE CATEGORY	B, C, D	B, C, D	B, C	B, C	B
MEAN ROOF HEIGHT	25'	15'	25'	15'	30'

DESIGN LOADS: +30.0 P.S.F. & -30.0 P.S.F.  
TEST LOADS: +45.0 P.S.F. & -45.0 P.S.F.

ORIGINAL DRAWINGS ARE SIGNED IN BLUE INK WITH A RAISED SEAL (EMBOSS).  
DESIGN ENGINEER  
MARK W. WESTERFIELD, P.E.  
FLORIDA P.E. #48495, NC P.E. #23832, TEXAS P.E. #91513

### WOOD JAMB ON CONCRETE

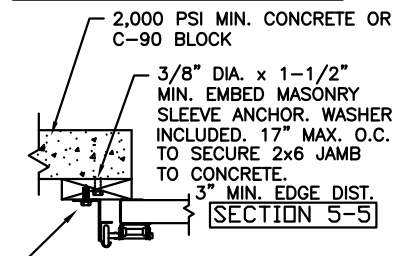

### SECTION 5-5

BRACKET MOUNT OR CONTINUOUS ANGLE MOUNT TRACK FASTENED TO 2X6 #2 OR BETTER YELLOW PINE JAMB WITH ONE 5/16"x1-5/8" LG. LAG SCREW PER BRACKET OR TRACK CLIP LOCATION.

### CONCRETE JAMBS

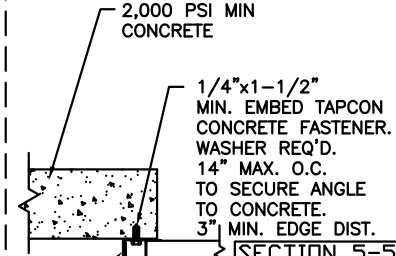

### SECTION 5-5

12 GA. GALV. REVERSE OR CONTINUOUS ANGLE MOUNT TRACK FASTENED DIRECTLY TO CONCRETE.

### STEEL JAMBS

### SECTION 5-5

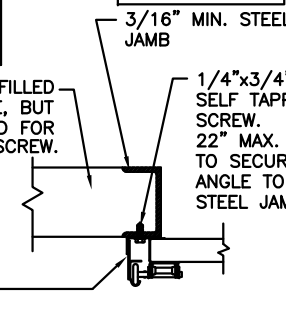

### WOOD JAMBS

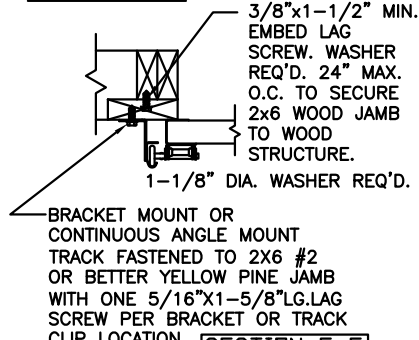

### SECTION 5-5

### STEEL JAMBS

### SECTION 5-5

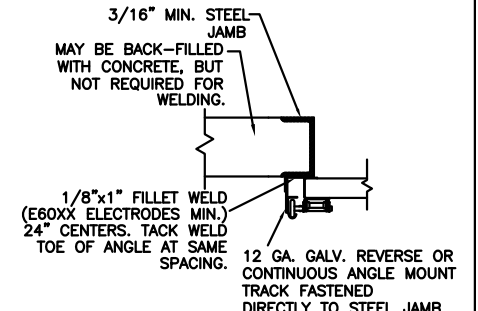

**Clopay**  
Building Products  
Company

CLOPAY BUILDING PRODUCTS COMPANY  
8585 DUKE BLVD.  
MASON, OH 45040  
(513) 770-4800  
CLOPAY CORP. ALL RIGHTS RESERVED.

MANUFACTURING PRODUCT CODE:  
MPC: C-AL-1F499  
DATE: 1-17-92  
DRAWN BY: LEG  
CHECKED BY:

WINDLOAD RATING	MANUFACTURED / PURCHASED
W5	MAN.
DESCRIPTION: MODEL 902: +30/-30 DES.	
D	VER: IBC
DRAWING NUMBER: 103295	