

CLOPAY MODEL 902, 903
IDEAL MODEL C2AL

UP TO 24'-2" WIDE X 18'-0" HIGH

REVISIONS					
REV. NO.	ZONE	DATE	ECN NO.	APPVD.	DESCRIPTION
03	-	02/2012	--	--	UPDATED WINDCODE CHART

THE OPTIONAL GLAZING SHOWN ON THIS DRAWING MEETS THE WIND LOAD REQUIREMENTS OF THE FLORIDA BUILDING CODE OR INTERNATIONAL BUILDING CODE BUT DOES NOT MEET THE IMPACT RESISTANT REQUIREMENT FOR WINDBORNE DEBRIS REGIONS (FBC / IBC CHAPTER 16).

DOOR IS MADE OF 6063-T5 ALUMINUM EXTRUSIONS.
WALL THICKNESS:
TOP & BOTTOM RAILS .075
INTER. TOP & BOTTOM RAILS .075
TOP HAS .1 x 1.875" FIN
INTER. TOP RAIL CAP .040
SINGLE & DOUBLE END STILES .075
CENTER STILES .062

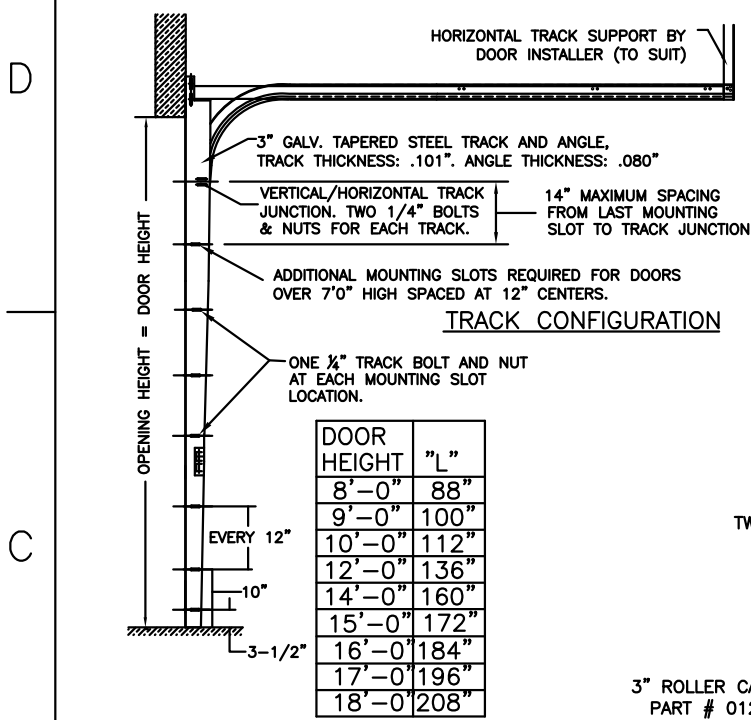

DOOR HEIGHT 'A'	NUMBER OF SECTIONS
UP TO 8'-0"	4
8'-3" THRU 10'-0"	5
10'-3" THRU 12'-0"	6
12'-3" THRU 14'-0"	7
14'-3" THRU 16'-0"	8
16'-3" THRU 18'-0"	9

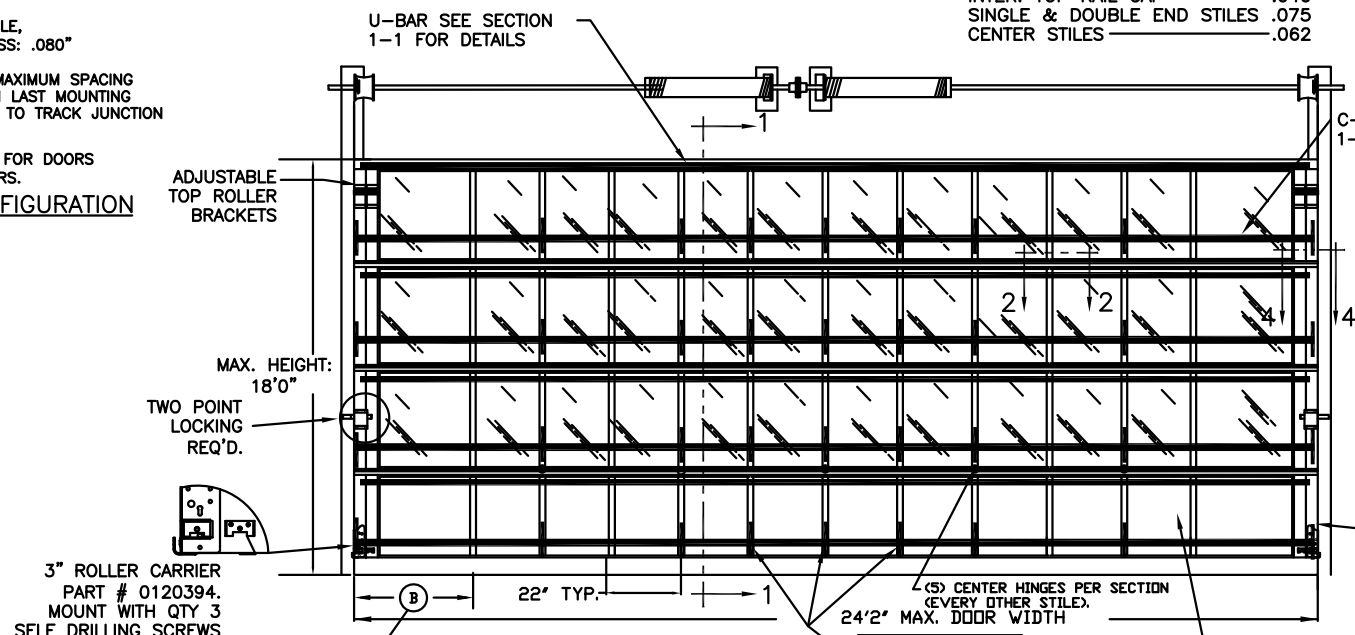

NOTE: CENTER STILES ALWAYS 22" FROM CENTER TO CENTER. FOR ANY GIVEN DOOR WIDTH, DIMENSION 'B' THIS DIMENSION WILL NOT BE GREATER THAN 40" OR LESS THAN 18"

AT THE CENTER OF EACH C-CHANNEL ATTACH THREE 6"x2-1/4"x12 GA. GALV. STEEL PLATE TO THE UNDERSIDE OF THE THE C-CHANNEL WITH (4) 1/4"x3/4" SELF TAPPING SCREWS.

PANEL IN BOTTOM SECTION CAN BE .050" THICK SMOOTH ALUMINUM.

VIEW "E"

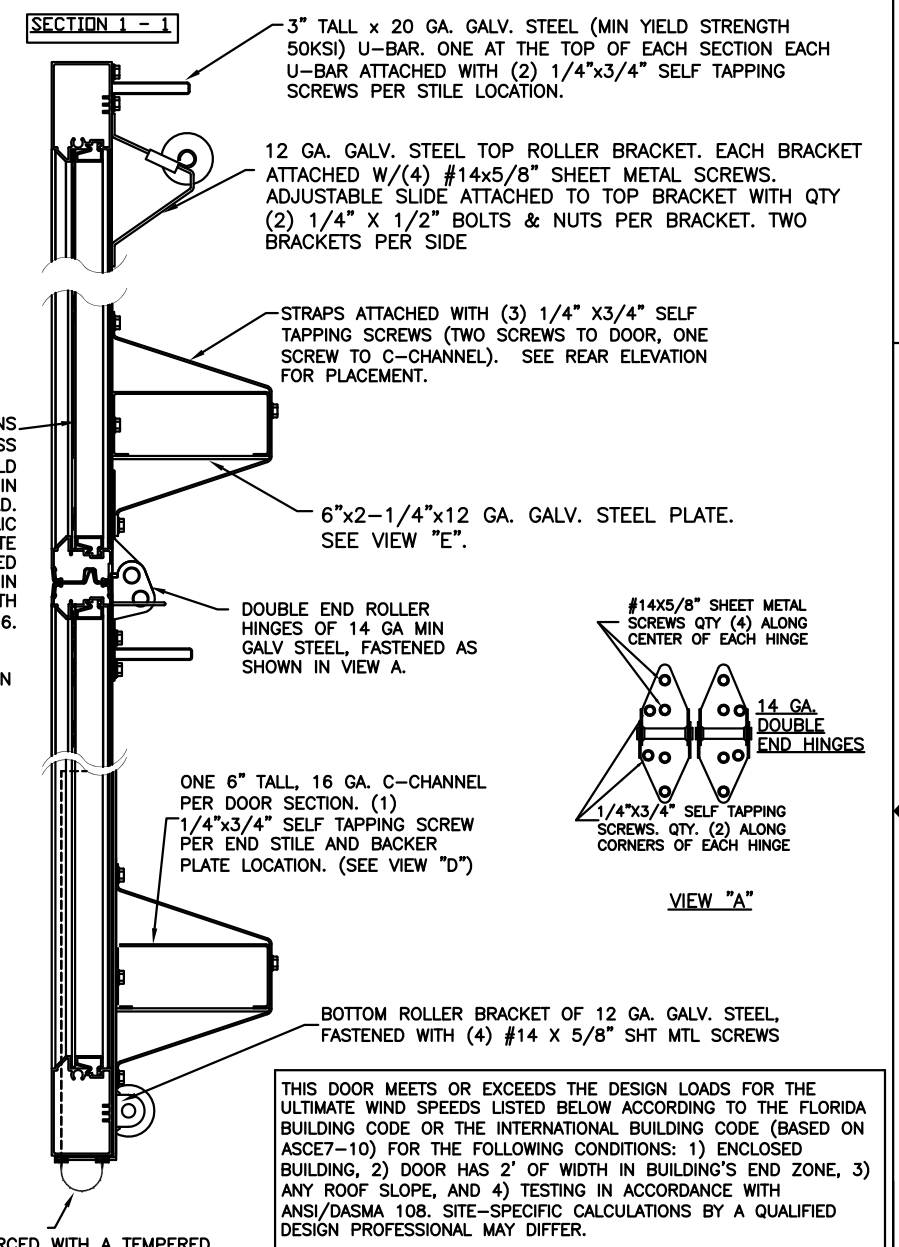

THIS DOOR MEETS OR EXCEEDS THE DESIGN LOADS FOR THE ULTIMATE WIND SPEEDS LISTED BELOW ACCORDING TO THE FLORIDA BUILDING CODE OR THE INTERNATIONAL BUILDING CODE (BASED ON ASCE7-10) FOR THE FOLLOWING CONDITIONS: 1) ENCLOSED BUILDING, 2) DOOR HAS 2' OF WIDTH IN BUILDING'S END ZONE, 3) ANY ROOF SLOPE, AND 4) TESTING IN ACCORDANCE WITH ANSI/DASMA 108. SITE-SPECIFIC CALCULATIONS BY A QUALIFIED DESIGN PROFESSIONAL MAY DIFFER.

ULTIMATE WIND SPEED (MPH)	125	130	140	145	160
EXPOSURE CATEGORY	B, C, D	B, C, D	B, C	B, C	B
MEAN ROOF HEIGHT	25'	15'	25'	15'	30'

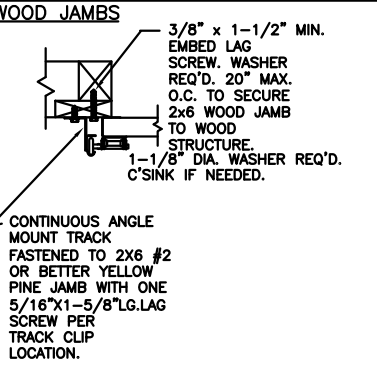
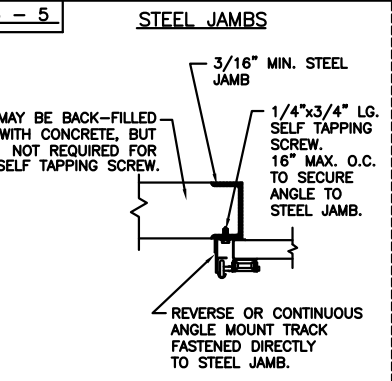
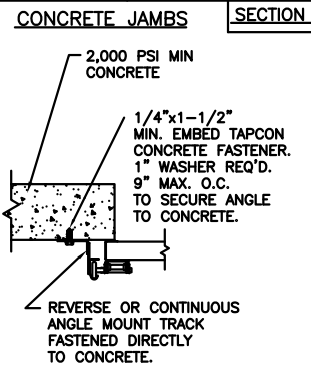
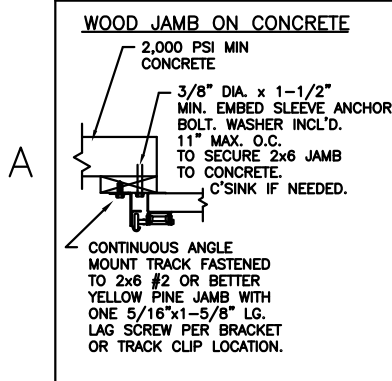
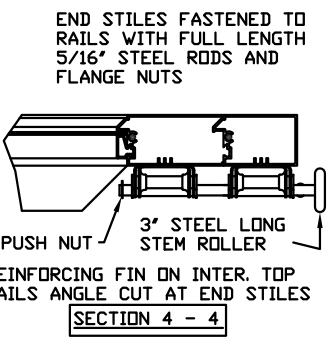
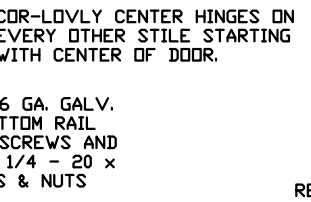
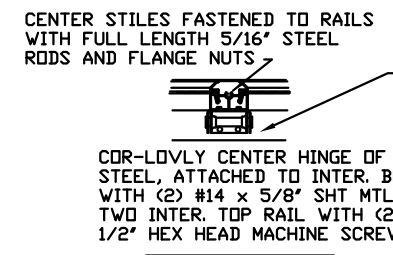
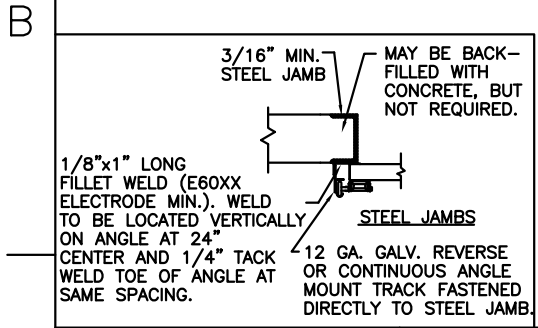

THE DESIGN OF THE SUPPORTING STRUCTURAL ELEMENTS IS THE RESPONSIBILITY OF THE BUILDING ENGINEER OR ARCHITECT OF RECORD.

DESIGN ENGINEER: MARK WESTERFIELD, P.E. FLORIDA P.E. #48495, NC P.E. #23832, TEXAS P.E. #91513
DESIGN LOADS: +25 & -25 P.S.F.
TEST LOADS +37.5 & -37.5 P.S.F.

MANUFACTURING PRODUCT CODE: MPC: C-AL-1F499

Unless Stated Otherwise TOLERANCES are

.0	= ±.031
.00	= ±.015
.000	= ±.005
.0000	= ±.001
Degrees	= ±1/2'

Unless Stated Otherwise DIMENSIONS ARE IN INCHES.

Glopay Building Products Company
8585 Duke Boulevard
Mason, OH 45040 USA
Tel. No. 513-770-4800
Fax No. 513-770-4853

CLOPAY WINDLOAD RATING
W4

DESCRIPTION: M/N 902, C2AL, 24'2" WIDE DES. +25/-25 PSF	SCALE: NONE	DWG. SIZE B
DRAWN BY: BFA	DATE: 11/30/04	SHEET 1 OF 1
CHECKED BY: -	DATE: -	VER: IBC
DWG. NO.: 103332		

