

MODEL 3200/3220/3300/240 UP TO 20'2"W x 18'0"H

CLOPAY MODEL 3200: 24 GA. EXTERIOR STEEL SKIN
 CLOPAY MODEL 3220: 20 GA. EXTERIOR STEEL SKIN
 CLOPAY MODEL 3300: 24 GA. EXTERIOR STEEL SKIN
 HOLMES MODEL 240: 24 GA. EXTERIOR STEEL SKIN

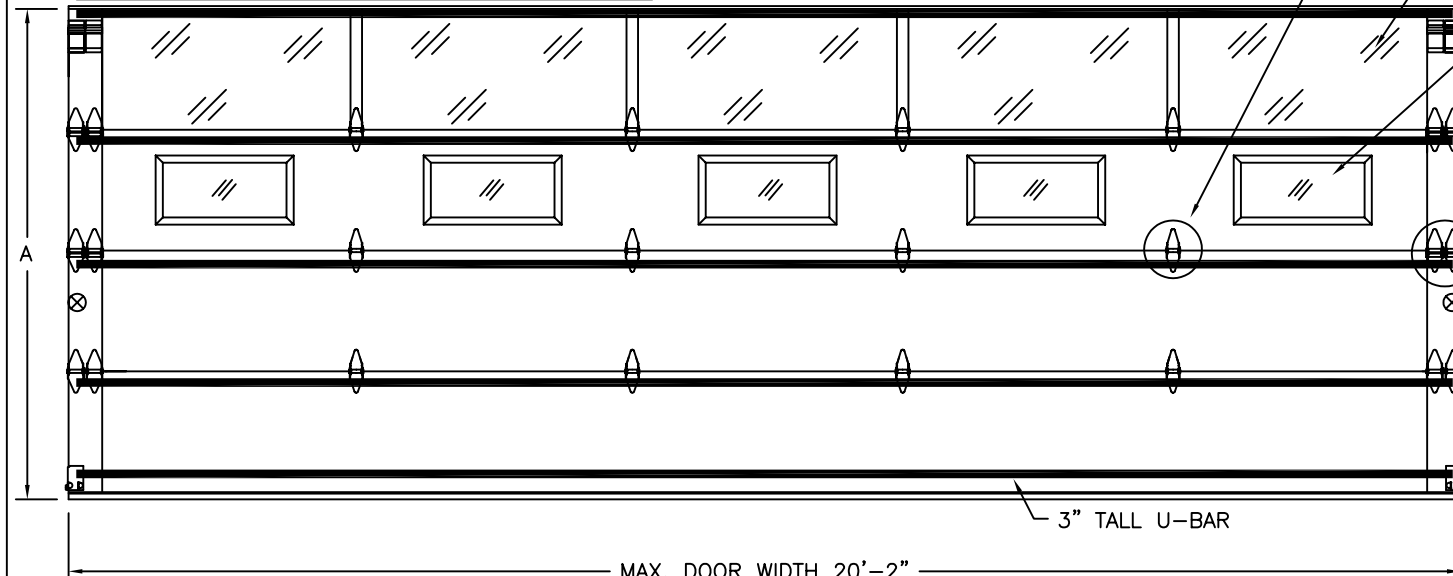

OPTIONAL ALUMINUM FULL VISION WINDOW LITE SECTIONS AVAILABLE (1/8" DSB, 1/8" ACRYLIC, 1/4" WIRE, 1/2" INSUL.). FULL VISION SECTIONS TO HAVE 3" STRUT & 2"x2" ANGLE. L-ANGLE NOT REQ'D FOR TOP SECTION. N/A FOR 3300 MODEL.

OPTIONAL 28" X 14" (MAX) DSB GLASS, INSULATED GLASS OR ACRYLIC WINDOW LITES.
 OPTIONAL ACRYLIC IS PLASKOLITE OPTIX, AN APPROVED CC2 PLASTIC IN COMPLIANCE WITH IBC/FBC 2606.
 SEE JAMB ATTACHMENT ILLUSTRATIONS

VERTICAL TRACK CAN BE EITHER BRACKET MOUNT, CONTINUOUS ANGLE OR REVERSE ANGLE TRACK. FASTENED TO JAMB WITH 5/16"x1-5/8" LAG SCREW OR 3/8"x1" SELF TAPPING SCREW EVERY 24".
 2" GALV. STEEL TRACK FASTENED TO 12 GA. GALV. STEEL TRACK CLIPS. TRACK ATTACHED TO EACH CLIP WITH ONE 1/4"x5/8" BOLT & NUT. EACH TRACK CLIP ATTACHED TO CONTINUOUS ANGLE WITH (2) 1/4" DIA. RIVETS PER CLIP.

NOTE: DOUBLE TRACK LOW HEADROOM, HI-LIFT TRACK, FOLLOW-THE-ROOF TRACK, AND VERTICAL LIFT TRACK ARE AVAILABLE OPTIONS. 3" TRACK ALSO AVAILABLE.

REV	DATE	DESCRIPTION
00	7/02/07	INITIAL RELEASE

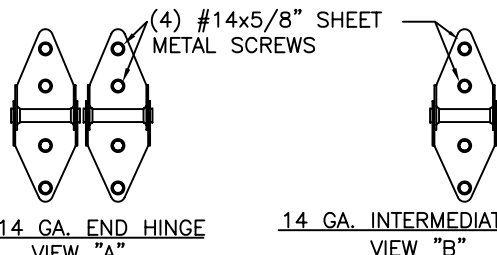
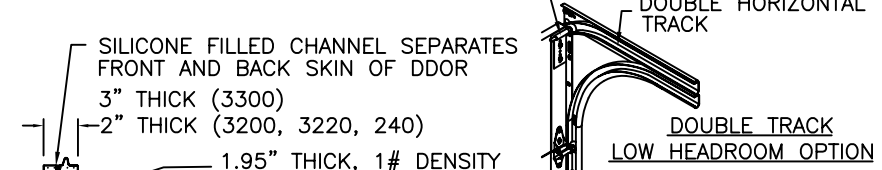
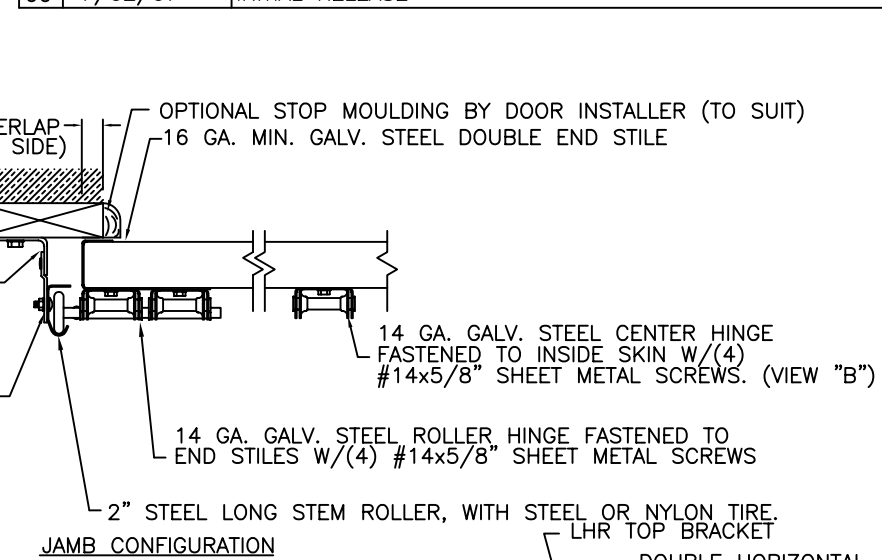

DOOR HEIGHT 'A'	NUMBER OF SECTIONS
8'-0"	4
8'-3" THRU 10'-0"	5
10'-3" THRU 12'-0"	6
12'-3" THRU 14'-0"	7
14'-3" THRU 16'-0"	8
16'-3" THRU 18'-0"	9

NOTE: THE DESIGN OF THE SUPPORTING STRUCTURAL ELEMENTS ARE THE RESPONSIBILITY OF THE PROFESSIONAL OF RECORD FOR THE BUILDING OR STRUCTURE AND IN ACCORDANCE WITH CURRENT BUILDING CODES FOR THE LOADS LISTED ON THIS DRAWING.

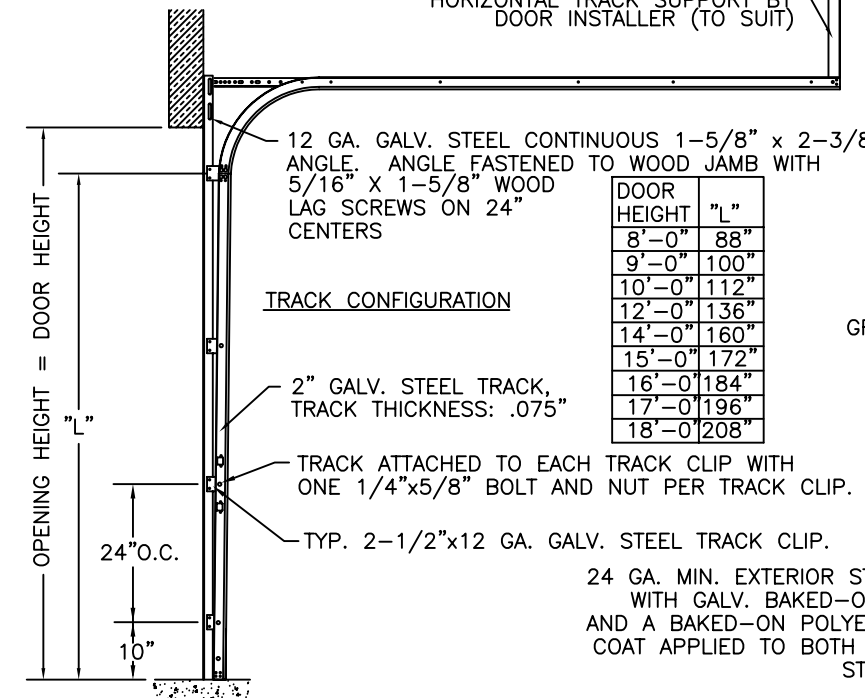
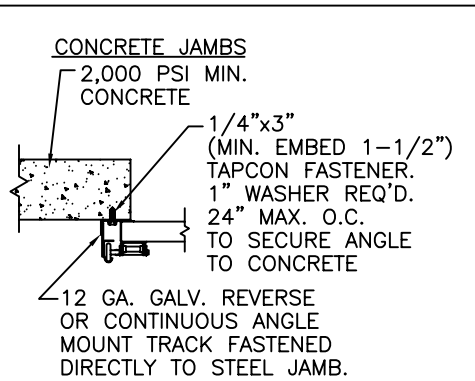
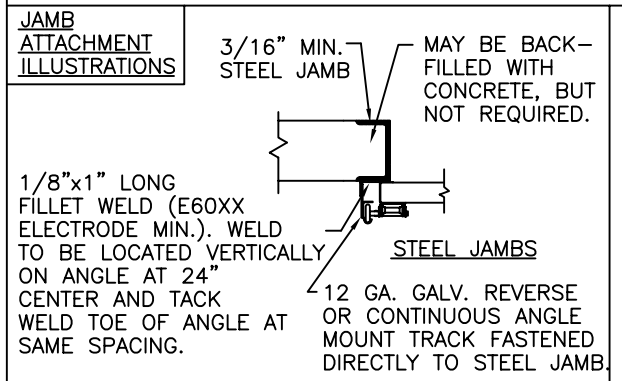

DOOR HEIGHT	"L"
8'-0"	88"
9'-0"	100"
10'-0"	112"
12'-0"	136"
14'-0"	160"
15'-0"	172"
16'-0"	184"
17'-0"	196"
18'-0"	208"

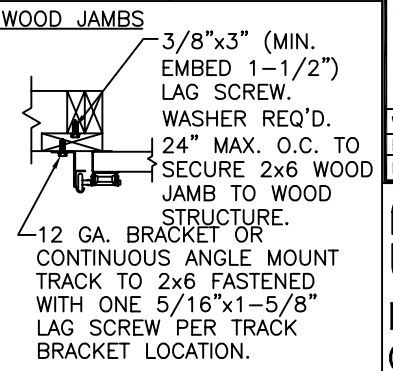
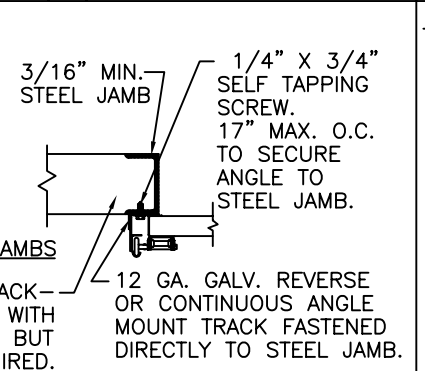
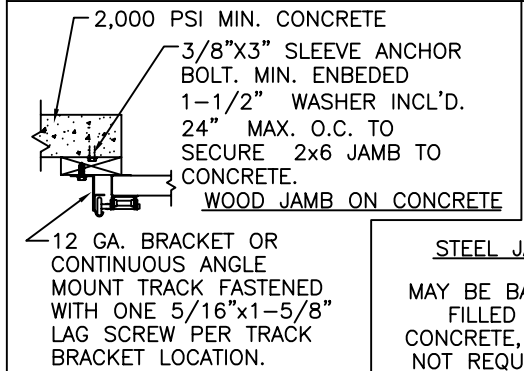
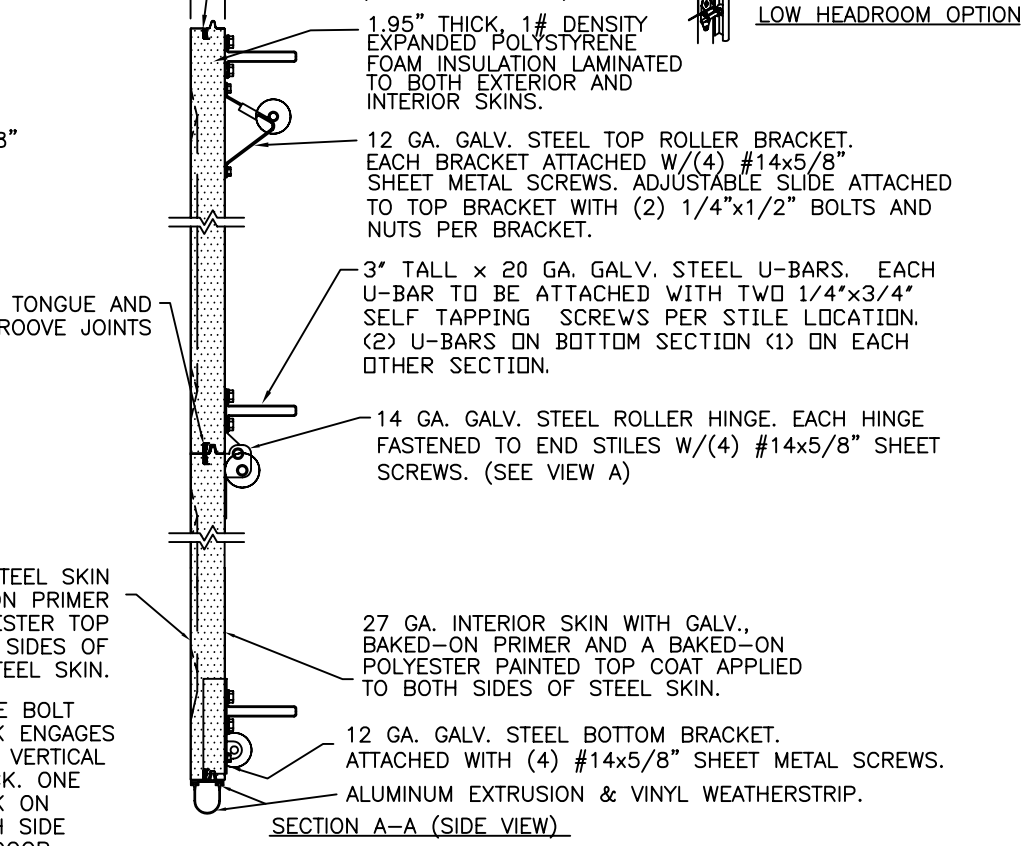

THIS DOOR MEETS OR EXCEEDS THE DESIGN LOADS FOR THE WIND SPEEDS LISTED BELOW ACCORDING TO THE INTERNATIONAL BUILDING CODE FOR THE FOLLOWING CONDITIONS: 1) ENCLOSED BUILDING, 2) DOOR HAS 2' OF WIDTH IN BUILDING'S END ZONE, 3) IMPORTANCE FACTOR OF 1.0, 4) ANY ROOF SLOPE, AND 5) 50% SAFETY FACTOR.

WIND SPEED (MPH)	≤ 90
EXPOSURE LEVEL	B
MEAN ROOF HEIGHT	≤ 30'

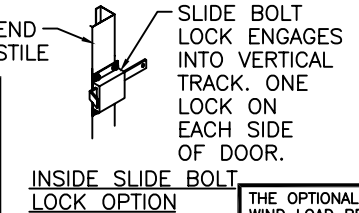

THE OPTIONAL GLAZING SHOWN ON THIS DRAWING MEETS THE WIND LOAD REQUIREMENTS OF THE FLORIDA BUILDING CODE OR INTERNATIONAL BUILDING CODE BUT DOES NOT MEET THE IMPACT RESISTANT REQUIREMENT FOR WINDBORNE DEBRIS REGIONS (REF. CHAPTER 16 FBC/IBC)

DESIGN ENGINEER: MARK WESTERFIELD, P.E. FLORIDA P.E. #48495, NC P.E. #23832, TEXAS P.E. #91513
 DESIGN LOADS: +13.5, -13.5 PSF
 TEST LOADS: +20, -20 PSF

Clopay
 Building Products
 Company

CLOPAY BUILDING PRODUCTS COMPANY
 8585 DUKE BLVD.
 MASON, OH 45040
 (513) 770-4800

Clopay Corporation All Rights Reserved.

SCALE:	NOTED	CLOPAY WINDLOAD RATING	W1	MAX. SIZE:	20'-2" X 18'-0"
DATE:	02/02/06	DESCRIPTION:	MODEL 3200/3220 WINDLOAD: 20'2"W		
DRAWN BY:	BFA	DRAWING NUMBER:	B	103619	
CHECKED BY:					