

CLOPAY MODEL 902, 903
IDEAL MODEL C2AL, C3AL

REVISIONS					
REV. NO.	ZONE:	DATE:	ECN NO.	APPVD:	DESCRIPTION
03	-	11/2008	-	-	ADDED MPC; UPDATED JAMB ATTACHMENT.
04	-	02/2012	-	-	UPDATED WINDCODE CHART

D
C
B
A

D
C
B
A

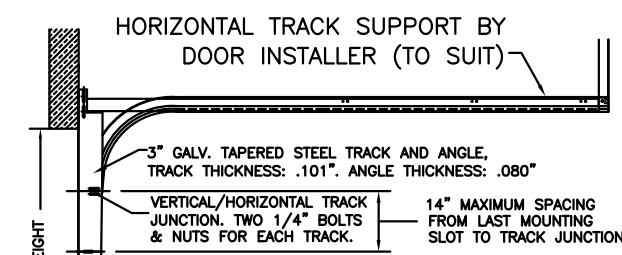

TRACK CONFIGURATION

DOOR HEIGHT "L"	"L"
8'-0"	88"
9'-0"	100"
10'-0"	112"
12'-0"	136"
14'-0"	160"
15'-0"	172"
16'-0"	184"
17'-0"	196"
18'-0"	208"
20'-0"	220"

DOOR HEIGHT 'A'	NUMBER OF SECTIONS
8'-0"	4
8'-3" THRU 10'-0"	5
10'-3" THRU 12'-0"	6
12'-3" THRU 14'-0"	7
14'-3" THRU 16'-0"	8
16'-3" THRU 18'-0"	9
18'-3" THRU 20'-0"	10

THE OPTIONAL GLAZING SHOWN ON THIS DRAWING MEETS THE WIND LOAD REQUIREMENTS OF THE FLORIDA BUILDING CODE OR INTERNATIONAL BUILDING CODE BUT DOES NOT MEET THE IMPACT RESISTANT REQUIREMENT FOR WINDBORNE DEBRIS REGIONS (REF. CHAPTER 16 FBC/IBC)

DOOR IS MADE OF 6063-T5 ALUMINUM EXTRUSIONS.
WALL THICKNESS:
TOP & BOTTOM RAILS .075
INTER. TOP & BOTTOM RAILS .075
TOP HAS .1 x 1.875" FIN
INTER. TOP RAIL CAP .040
SINGLE & DOUBLE END STILES .075
CENTER STILES .062

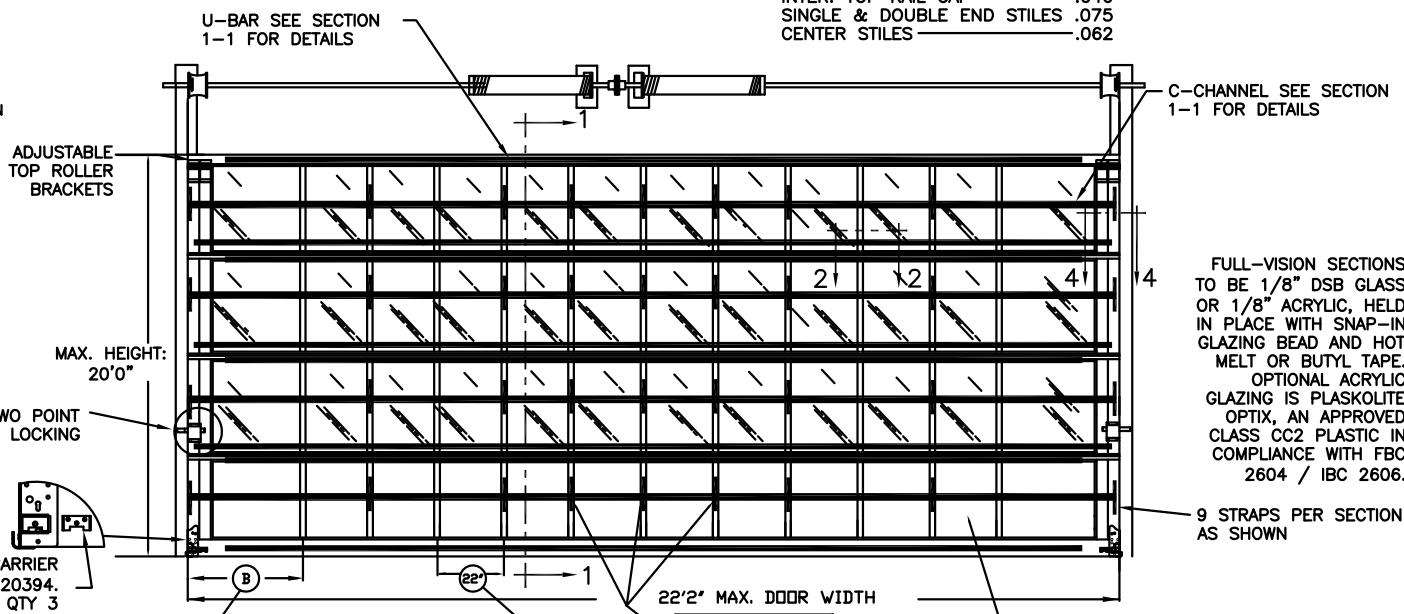

NOTE FOR 902, C2AL:

CENTER STILES ALWAYS 22" FROM CENTER TO CENTER. FOR ANY GIVEN DOOR WIDTH, DIMENSION 'B' THIS DIMENSION WILL NOT BE GREATER THAN 40" OR LESS THAN 18"

SECTION 1-1

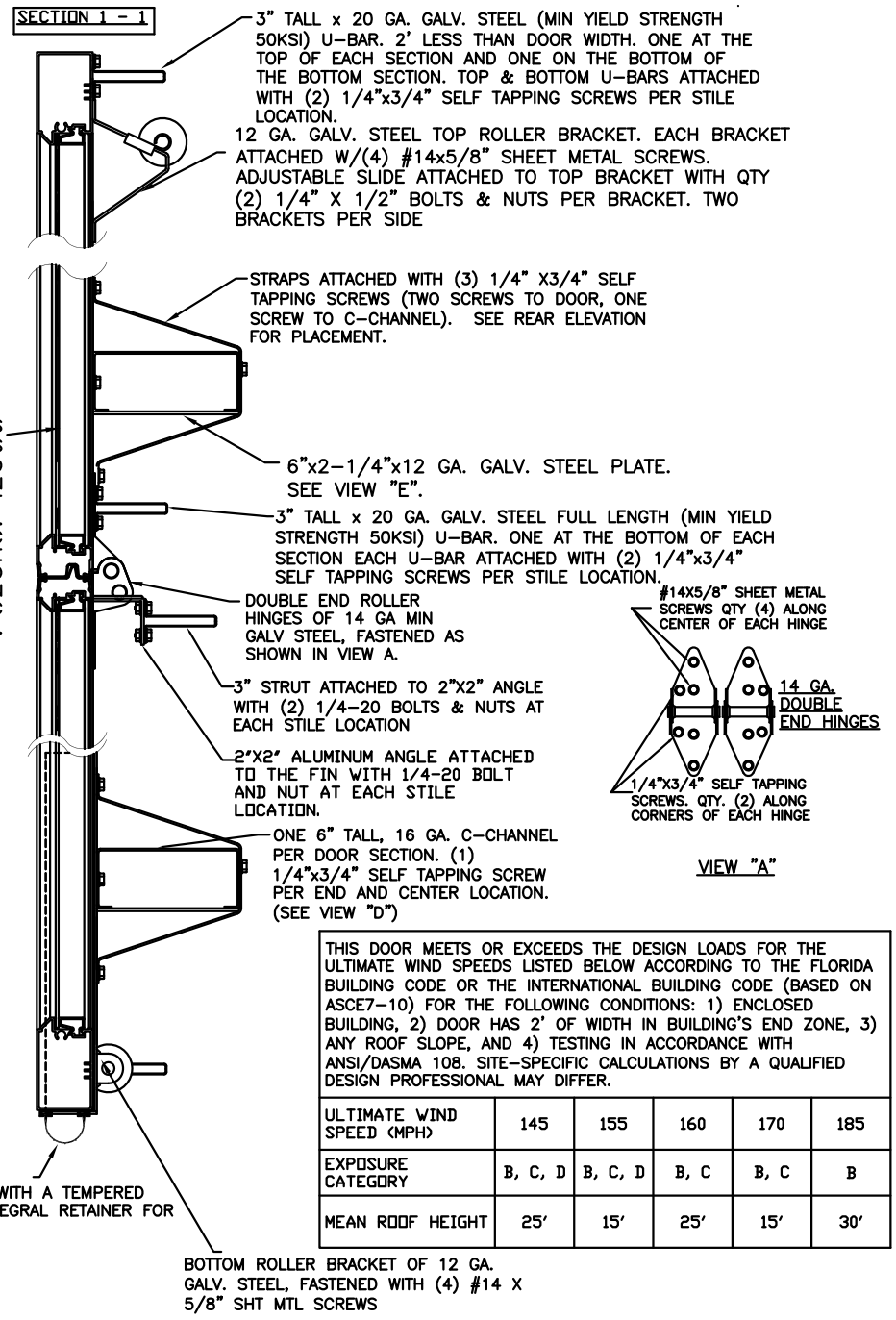

VIEW "A"

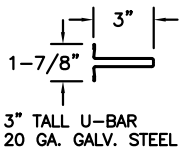
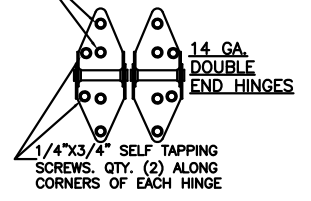

VIEW "D"

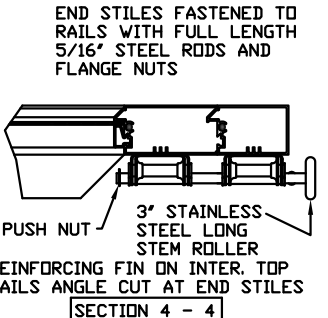

SECTION 4-4

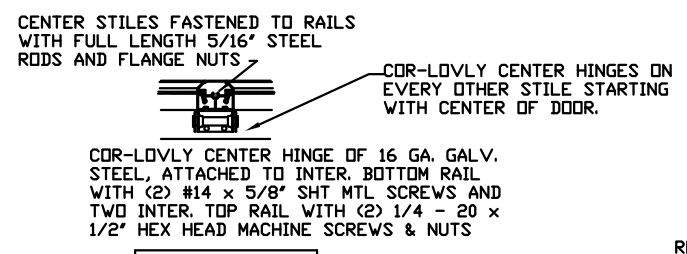

SECTION 2-2

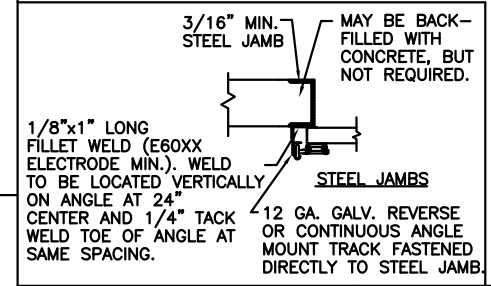

WOOD JAMB ON CONCRETE

CONCRETE JAMBS

SECTION 5-5

STEEL JAMBS

WOOD JAMBS

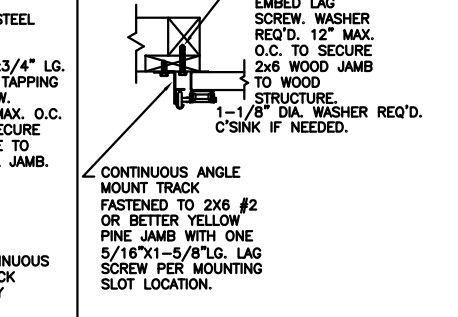
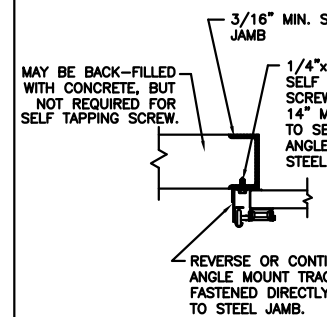
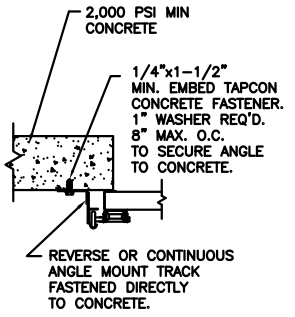
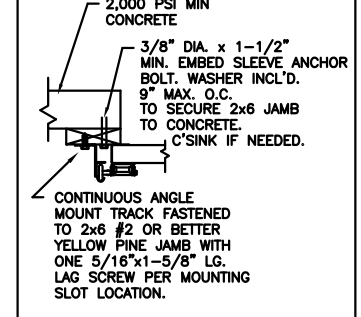

THE DESIGN OF THE SUPPORTING STRUCTURAL ELEMENTS IS THE RESPONSIBILITY OF THE BUILDING ENGINEER OR ARCHITECT OF RECORD.

DESIGN ENGINEER: MARK WESTERFIELD, P.E.
FLORIDA P.E. #48495, NC P.E. #23832, TEXAS P.E. #91513
DESIGN LOADS: +33 & -34 P.S.F.
TEST LOADS +49.5 & -51 P.S.F.

MANUFACTURING PRODUCT CODE:
MPC: C-AL-1F499

Unless Stated Otherwise TOLERANCES are

.0	= ±.031
.00	= ±.015
.000	= ±.005
.0000	= ±.001
Degrees	= ±1/2"

Clopay Building Products Company
8585 Duke Boulevard
Mason, OH 45040 USA
Tel. No. 513-770-4800
Fax No. 513-770-4853

CLOPAY WINDLOAD RATING
W6

DESCRIPTION: M/N 902, 22'2" WIDE DES. +33/-34 PSF

DRAWN BY: BFA DATE: 10/03/06 SCALE: NONE DWG. NO.: 103800

CHECKED BY: - DATE: - SHEET 1 OF 1 SIZE B VER: IBC

CLOPAY CORP.
ALL RIGHTS RESERVED.



Unless Stated Otherwise DIMENSIONS ARE IN INCHES.