

BRAND	1 3/4" THICK MODELS	2" THICK MODELS
CLOPAY	3717W1, 3718W1	3720W1, 3722W1
HOLMES	-	240UW1
IDEAL	C7X17W1, C7X18W1	C7X20W1, C0X22W1

MAX DOOR SIZE
14'-2" WIDE X 18'-0" HIGH

REVISIONS					
REV. NO.	ZONE:	DATE:	ECN NO.	APPVD:	DESCRIPTION
00	-	3/31/08	ER1173	SH	INITIAL RELEASE

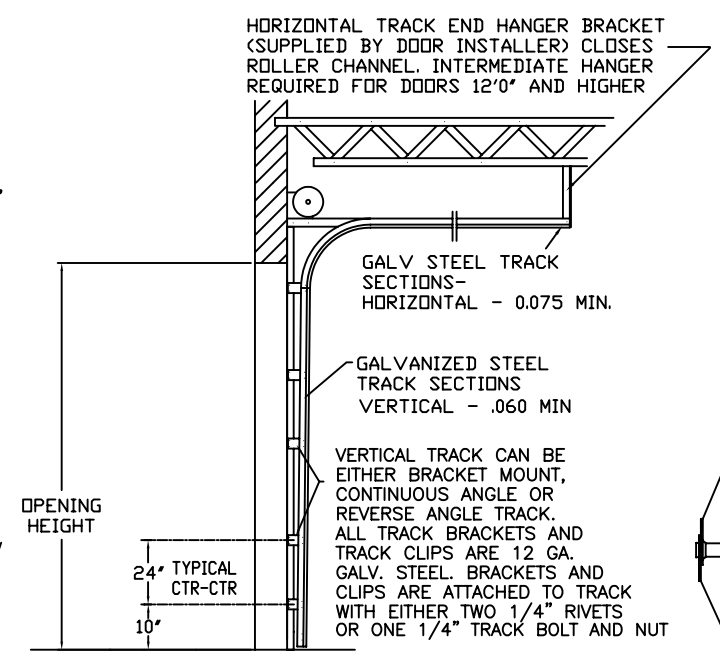
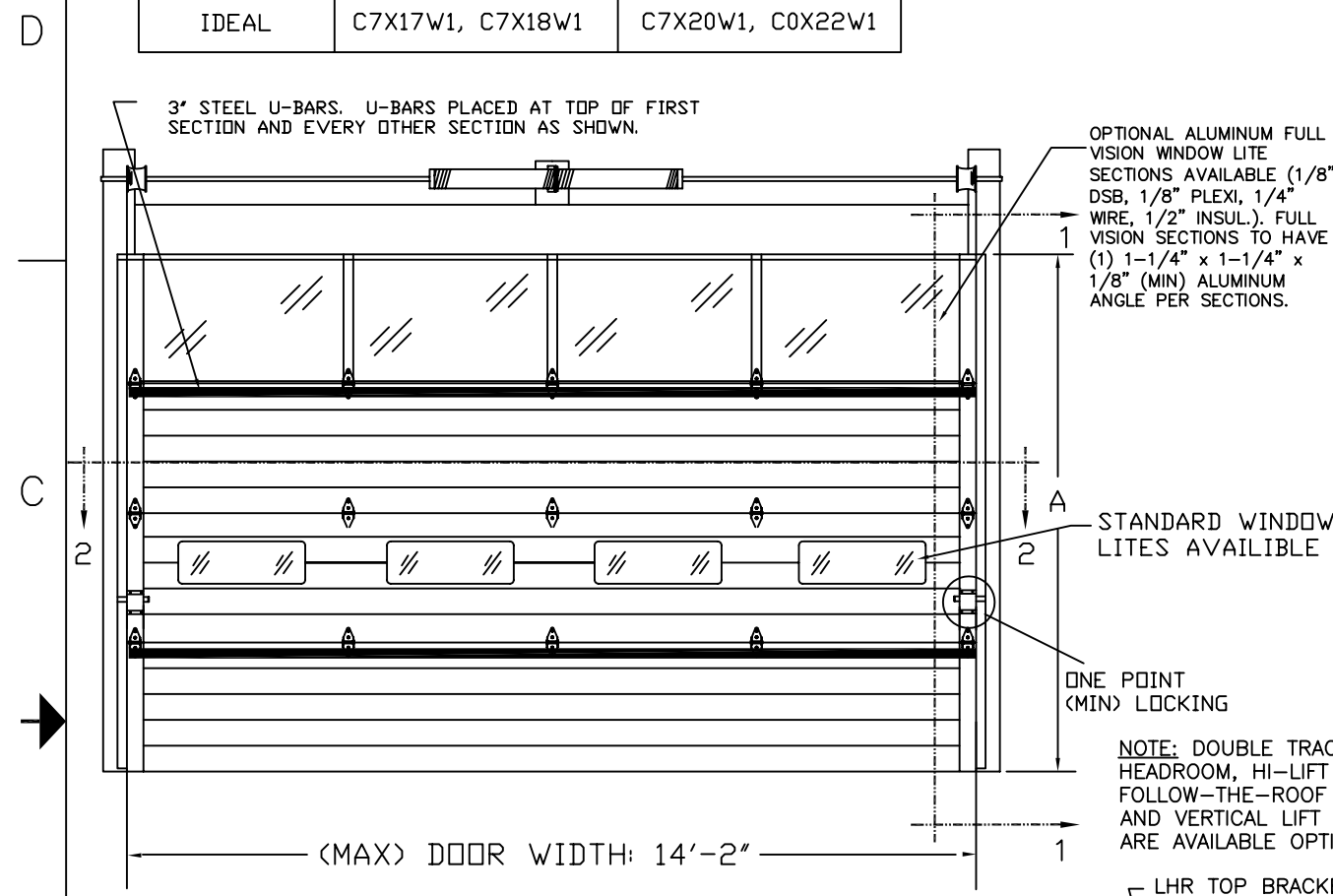

SECTIONS ARE 1-3/4"(MIN) THICK PANELS. EXTERIOR 27 GA. MIN. GALV. STEEL. INTERIOR 27 GA. MIN. GALV. STEEL. THE STUCCO EMBOSSED STEEL TEXTURE IS PREPAINTED WITH A BAKED POLYESTER PAINT. OPTIONAL MINOR RIBS ARE PLACED EVERY 4 INCHES ALONG THE WIDTH OF THE EXTERIOR AND INTERIOR PANELS.

HINGE DETAIL

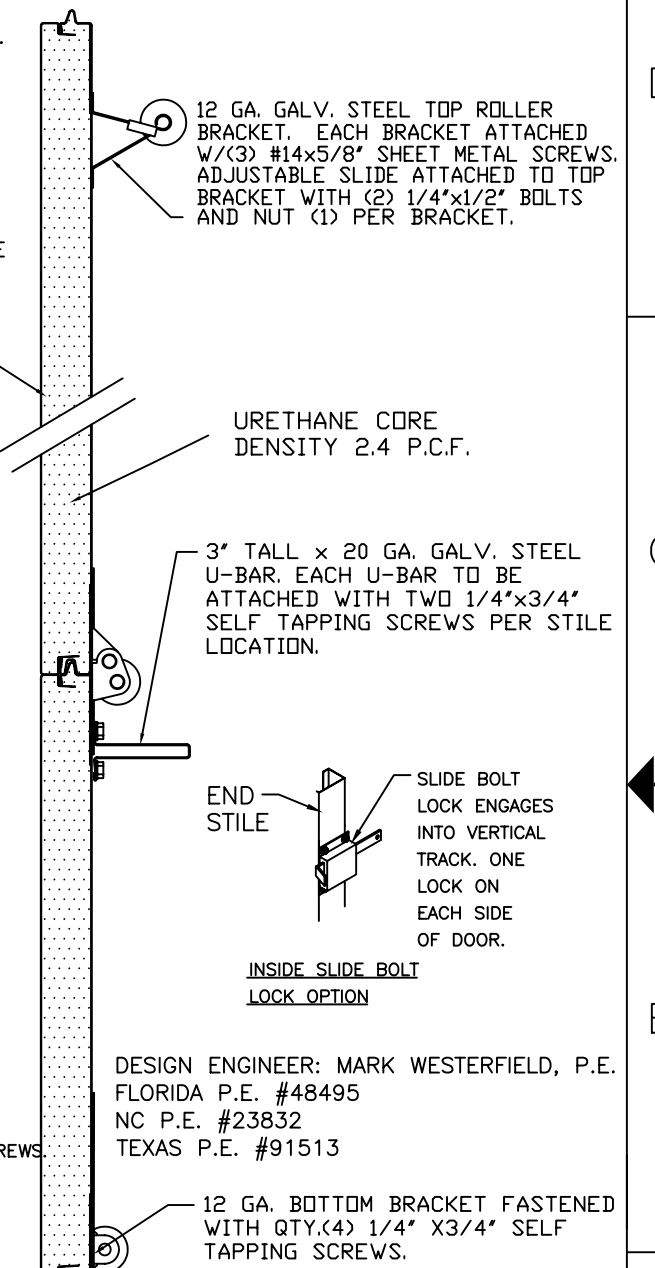
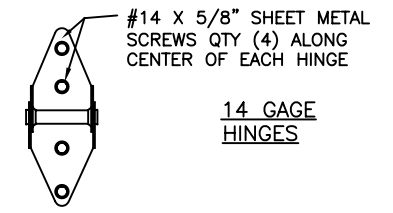

SIDE ELEVATION STANDARD-LIFT TRACK DETAILS

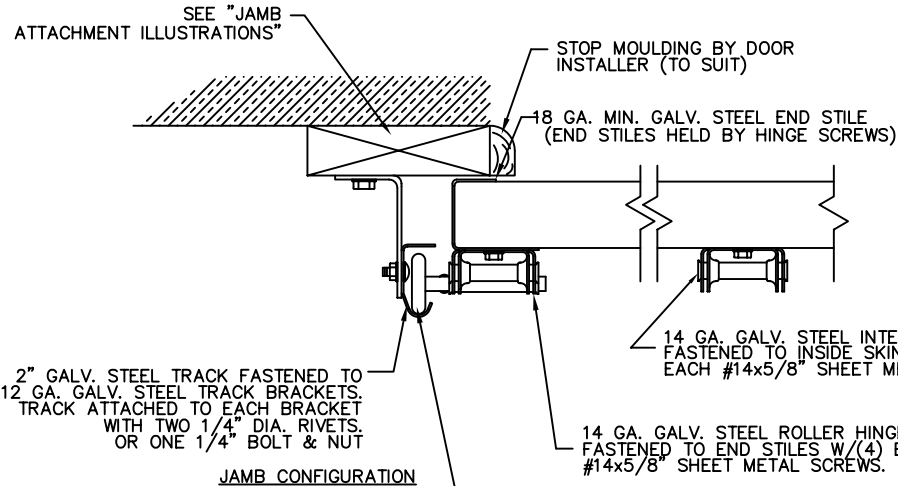

DOOR HEIGHT 'A'	NUMBER OF SECTIONS
3'-0" THRU 4'-0"	2
4'-6" THRU 6'-0"	3
6'-3" THRU 8'-0"	4
8'-3" THRU 10'-0"	5
10'-3" THRU 12'-0"	6
12'-3" THRU 14'-0"	7
14'-3" THRU 16'-0"	8
16'-3" THRU 18'-0"	9

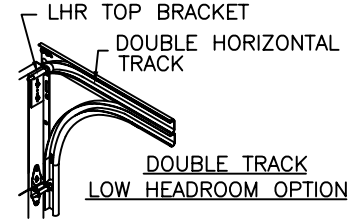
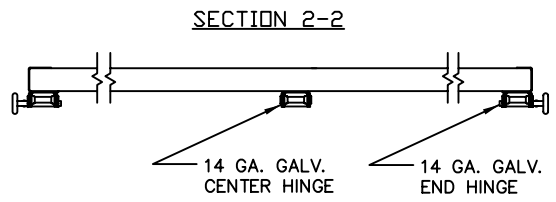

NOTE: DOUBLE TRACK LOW HEADROOM, HI-LIFT TRACK, FOLLOW-THE-ROOF TRACK, AND VERTICAL LIFT TRACK ARE AVAILABLE OPTIONS.

ANCHOR NOTE: FIRST (BOTTOM) ANCHOR STARTING AT NO MORE THAN HALF OF THE MAXIMUM ON-CENTER DISTANCE. HIGHEST ANCHOR INSTALLED AT LEAST AS HIGH AS THE DOOR OPENING.

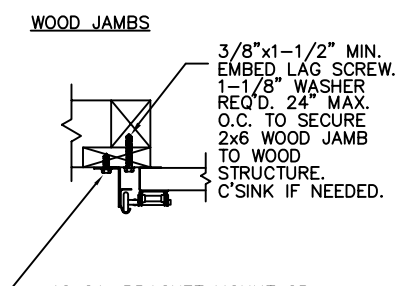
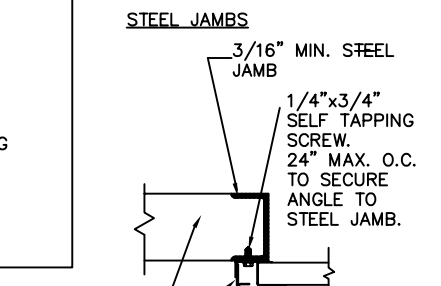
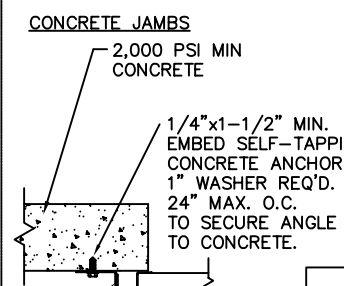
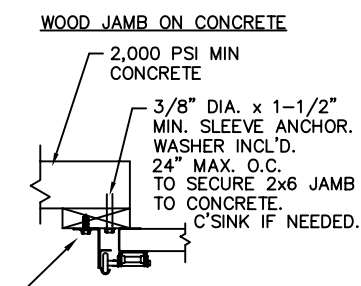

BOTTOM SECTION USES ALUM. EXTRUDED RETAINER FOR FLEXIBLE VINYL ASTRAGAL

DESIGN LOADS: +13.5 & -13.5 PSF TEST LOADS +20 & -20 PSF

NOTICE: Confidential/Proprietary information of CLOPAY BUILDING PRODUCTS CO. is contained herein and may not be disclosed, used, duplicated, made available, or distributed without its prior consent. Failure to observe this notice may result in liability for any damages and losses resulting therefrom.

Unless Stated Otherwise TOLERANCES are
.0 = ±.031
.00 = ±.015
.000 = ±.005
.0000 = ±.001
Degrees = ±1/2°

Clopay
Building Products Company

8585 Duke Boulevard
Mason, OH 45040 USA
Tel. No. 513-770-4800
Fax No. 513-770-4853

PART NO.: N/A
CLOPAY WINDLOAD RATING
W1

DESCRIPTION: MODEL 3717W1 14' WIDE	DRAWN BY: BFA	DATE: 2/15/08	SCALE: N/A	DWG. SIZE B
CHECKED BY: SH	DATE: 2/15/08	SHEET 1 OF 1	REV. NO. 00	
DWG. NO.: 104092				



Unless Stated Otherwise DIMENSIONS ARE IN INCHES.