

MAX 24'-2" WIDE X 18'-0" HIGH

MODELS AVAILABLE (CLOPAY/ HOLMES/ IDEAL)
 MODELS 524, 520/ 224/ C4ST, C0ST
 INSULATED MODELS 524S, 520S, 524V/ 224S/ C4SS, C0SS, C4SV

REVISIONS					
REV. NO.	ZONE:	DATE:	ECN NO.	APPVD:	DESCRIPTION
00	--	10/10	-	-	INITIAL RELEASE.

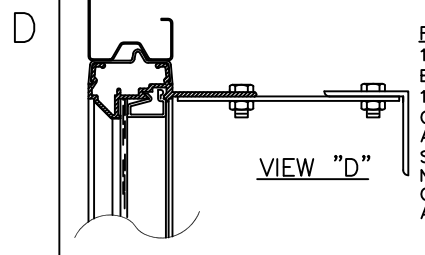

FULL VISIONS SECTION REINFORCEMENT:
 1/8" X 4" X 6" ALUMINUM OFF-SET PLATE BOLTED TO EACH REINFORCING RIB WITH (2) 1/4" HEX BOLTS & FLANGE NUTS AT EACH OFFSET PLATE LOCATION. 2" X 2" X 1/8" ALUMINUM ANGLES BOLTED TO PLATES AS SHOWN WITH 1/4" HEX BOLTS & FLANGE NUTS AT EACH OFFSET PLATE LOCATION. OFFSET PLATES LOCATED AT EACH STILE & AT CENTER OF EACH PANEL.

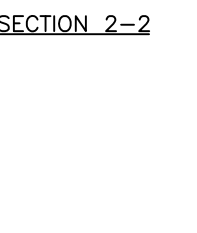
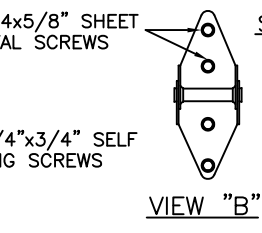
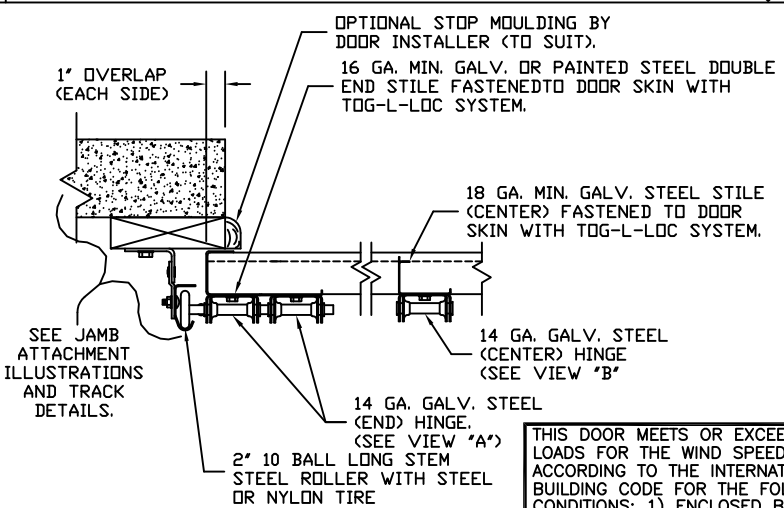

OPTIONAL STOP MOULDING BY DOOR INSTALLER (TO SUIT).
 16 GA. MIN. GALV. OR PAINTED STEEL DOUBLE END STILE FASTENED TO DOOR SKIN WITH TOG-L-LOC SYSTEM.
 18 GA. MIN. GALV. STEEL STILE (CENTER) FASTENED TO DOOR SKIN WITH TOG-L-LOC SYSTEM.
 14 GA. GALV. STEEL (CENTER) HINGE (SEE VIEW 'B')
 14 GA. GALV. STEEL (END) HINGE. (SEE VIEW 'A')
 2" 10 BALL LONG STEM STEEL ROLLER WITH STEEL OR NYLON TIRE

THIS DOOR MEETS OR EXCEEDS THE DESIGN LOADS FOR THE WIND SPEEDS LISTED BELOW ACCORDING TO THE INTERNATIONAL BUILDING CODE FOR THE FOLLOWING CONDITIONS: 1) ENCLOSED BUILDING, 2) DOOR HAS 2' OF WIDTH IN BUILDING'S END ZONE, 3) IMPORTANCE FACTOR OF 1.0, 4) ANY ROOF SLOPE, AND 5) 50% SAFETY FACTOR.

WIND SPEED (MPH)	≤ 90
EXPOSURE LEVEL	B
MEAN ROOF HEIGHT	≤ 30'

THE OPTIONAL GLAZING SHOWN ON THIS DRAWING MEETS THE WIND LOAD REQUIREMENTS OF THE FLORIDA BUILDING CODE OR INTERNATIONAL BUILDING CODE BUT DOES NOT MEET THE IMPACT RESISTANT REQUIREMENT FOR WINDBORNE DEBRIS REGIONS (FBC / IBC CHAPTER 16).

DOOR HEIGHT 'A'	NUMBER OF SECTIONS
UP TO 8'-0"	4
8'-3" THRU 10'-0"	5
10'-3" THRU 12'-0"	6
12'-3" THRU 14'-0"	7
14'-3" THRU 16'-0"	8
16'-3" THRU 18'-0"	9

DOOR WIDTH	NUMBER OF CENTER STILES	NUMBER OF C-CHANNEL STRAPS
20'-3" THRU 24'-2"	5	7

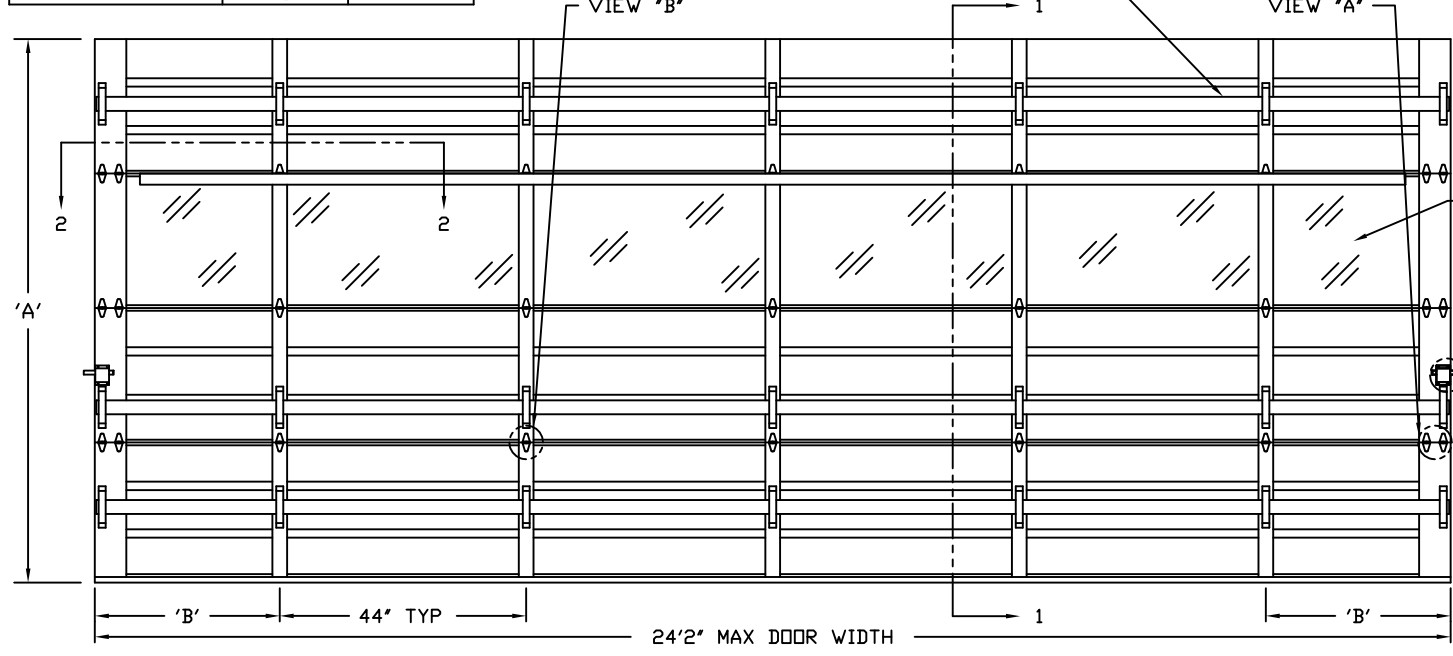

OPTIONAL ALUMINUM FULL VISION WINDOW LITE SECTIONS AVAILABLE (1/8" DSB, 1/8" ACRYLIC, OR BETTER). FULL VISION SECTIONS TO HAVE 2" X 2" ANGLE REINFORCEMENTS WITH OFFSET PLATE. SEE DETAIL VIEW "D".

NOTE: CENTER STILES ARE ALWAYS 44" FROM CENTER TO CENTER FOR ANY GIVEN DOOR WIDTH. DIMENSION 'B' IS THE LEFTOVER DIMENSION ON BOTH ENDS OF THE DOOR.

THE DESIGN OF THE SUPPORTING STRUCTURAL ELEMENTS IS THE RESPONSIBILITY OF THE BUILDING ENGINEER OR ARCHITECT OF RECORD.

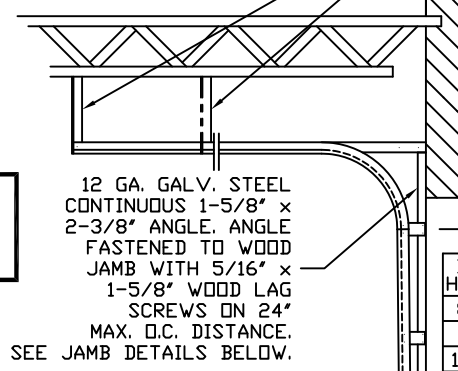

12 GA. GALV. STEEL CONTINUOUS 1-5/8" X 2-3/8" ANGLE, ANGLE FASTENED TO WOOD JAMB WITH 5/16" X 1-5/8" WOOD LAG SCREWS ON 24" MAX. O.C. DISTANCE. SEE JAMB DETAILS BELOW.
 2" GALV. STEEL TRACK .075 MIN. TRACK THICKNESS.
 VERTICAL TRACK TO BE EITHER, CONTINUOUS ANGLE, OR REVERSE ANGLE TRACK. ALL TRACK CLIPS ARE 12 GA. GALV. STEEL. CLIPS ARE ATTACHED TO TRACK WITH EITHER TWO 1/4" RIVETS OR ONE 1/4" BOLT.

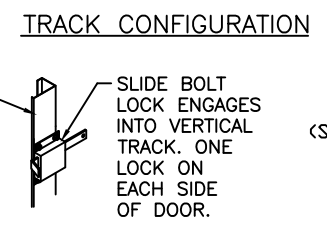

SLIDE BOLT LOCK ENGAGES INTO VERTICAL TRACK. ONE LOCK ON EACH SIDE OF DOOR.

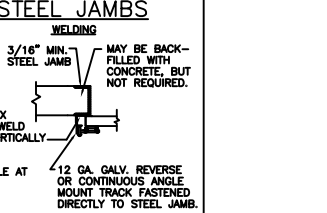

1/8" X 1" LONG FILET WELD (EROWK ELECTRODE MIN.). WELD TO BE LOCATED VERTICALLY ON ANGLE AT 24" CENTER AND TRACK WELD TOE OF ANGLE AT SAME SPACING.
 3/16" MIN. STEEL JAMB MAY BE BACK-FILLED WITH CONCRETE, BUT NOT REQUIRED.
 12 GA. GALV. REVERSE OR CONTINUOUS ANGLE MOUNT TRACK FASTENED DIRECTLY TO STEEL JAMB.

HORIZONTAL TRACK END HANGER BRACKET (SUPPLIED BY DOOR INSTALLER) CLOSES ROLLER CHANNEL. INTERMEDIATE HANGER REQ'D FOR DOORS IF HORIZONTAL TRACK DEFLECTION EXCEEDS 1/240TH OF DOOR HEIGHT.

NOTE: DOUBLE TRACK LOW HEADROOM, HI-LIFT TRACK, FOLLOW-THE-ROOF TRACK, AND VERTICAL LIFT TRACK ARE AVAILABLE OPTIONS. 3" TRACK ALSO AVAILABLE.

DOOR HEIGHT "L"	"L"
8'-0"	88"
9'-0"	100"
10'-0"	112"
12'-0"	136"
14'-0"	160"
15'-0"	172"
16'-0"	184"
17'-0"	194"
18'-0"	204"

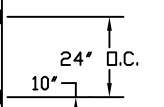

24" D.C.
 10"
 3-1/2"

VIEW "C"
 6" TALL C-CHANNEL 16 GA. GALV. STEEL MIN YIELD STRENGTH 50KSI

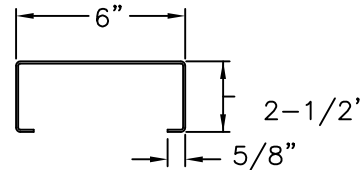

ADJUSTABLE TOP ROLLER BRACKET OF 12 GA. GALV. STEEL. EACH BRACKET ATTACHED W/ (4) #14X5/8" SHEET METAL SCREWS.

1-1/4" WIDE X 16 GA. GALV. STEEL STRAP. EACH STRAP ATTACHED W/ (3) 1/4" X 3/4" SELF TAPPING SCREWS (TWO SCREWS TO DOOR SECTION, ONE SCREW TO C-CHANNEL).

(1) 6" X 16 GA. C-CHANNEL PER DOOR SECTION.
 (1) 1/4" X 3/4" SELF TAPPING SCREW PER STILE LOCATION. (SEE VIEW "C")

CENTER HINGES: SEE VIEW "A".
 ROLLER (END) HINGE: SEE VIEW "B".

BOTTOM ROLLER BRACKET OF 12 GA. GALV. STEEL FASTENED W/ (4) #14X5/8" SHEET METAL SCREWS

ALUMINUM EXTRUSION AND VINYL WEATHERSTRIP

SECTIONS ARE 1-7/8" THK PANELS ROLL FORMED OF 24GA. MIN. HOT DIPPED GALVANIZING, ROLL FORMED STEEL.

MARK WESTERFIELD, P.E.
 FLORIDA P.E. #48495,
 NC P.E. #23832, TEXAS P.E. #91513

DESIGN LOADS: +13.3 & -13.3 P.S.F.
 TEST LOADS +20.0 & -20.0 P.S.F.

MANUFACTURING PRODUCT CODE: MPC: C-PAN-1E448

WOOD JAMB ON CONCRETE

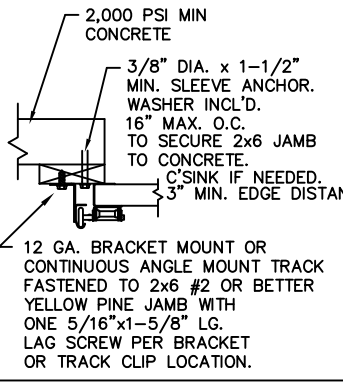

CONCRETE JAMBS

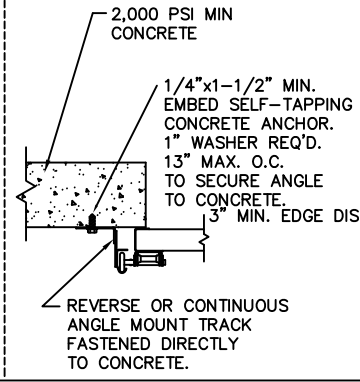

STEEL JAMBS

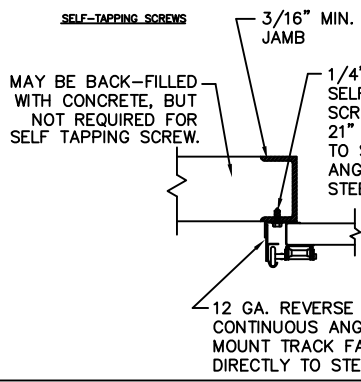

WOOD JAMBS

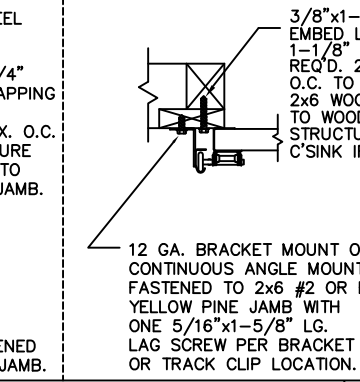

Unless Stated Otherwise TOLERANCES are
 .0 = ±.031
 .00 = ±.015
 .000 = ±.005
 .0000 = ±.001
 Degrees = ±1/2"
 Unless Stated Otherwise DIMENSIONS ARE IN INCHES.

CLOPAY CORP. ALL RIGHTS RESERVED.
 8585 Duke Boulevard
 Mason, OH 45040 USA
 Tel. No. 513-770-4800
 Fax No. 513-770-4853

CLOPAY WINDLOAD RATING
 W1
 DESCRIPTION: COMMERCIAL RIBBED DOOR, +/- 14 PSF DESIGN LOAD
 DRAWN BY: SH DATE: 10/11/10 SCALE: NTS DWG. SIZE B
 CHECKED BY: SH DATE: 10/11/10 SHEET 1 OF 1
 DWG. NO.: 104365 VER: IBC