

VERTICAL-LIFT TRACK

Vertical-lift commercial track is available for all building applications as an option when headroom along the wall above the door opening is available. This type of track mounts completely to the wall of the building. Clearance requirements are presented below. Jackshaft motor operators are available for this type of track.

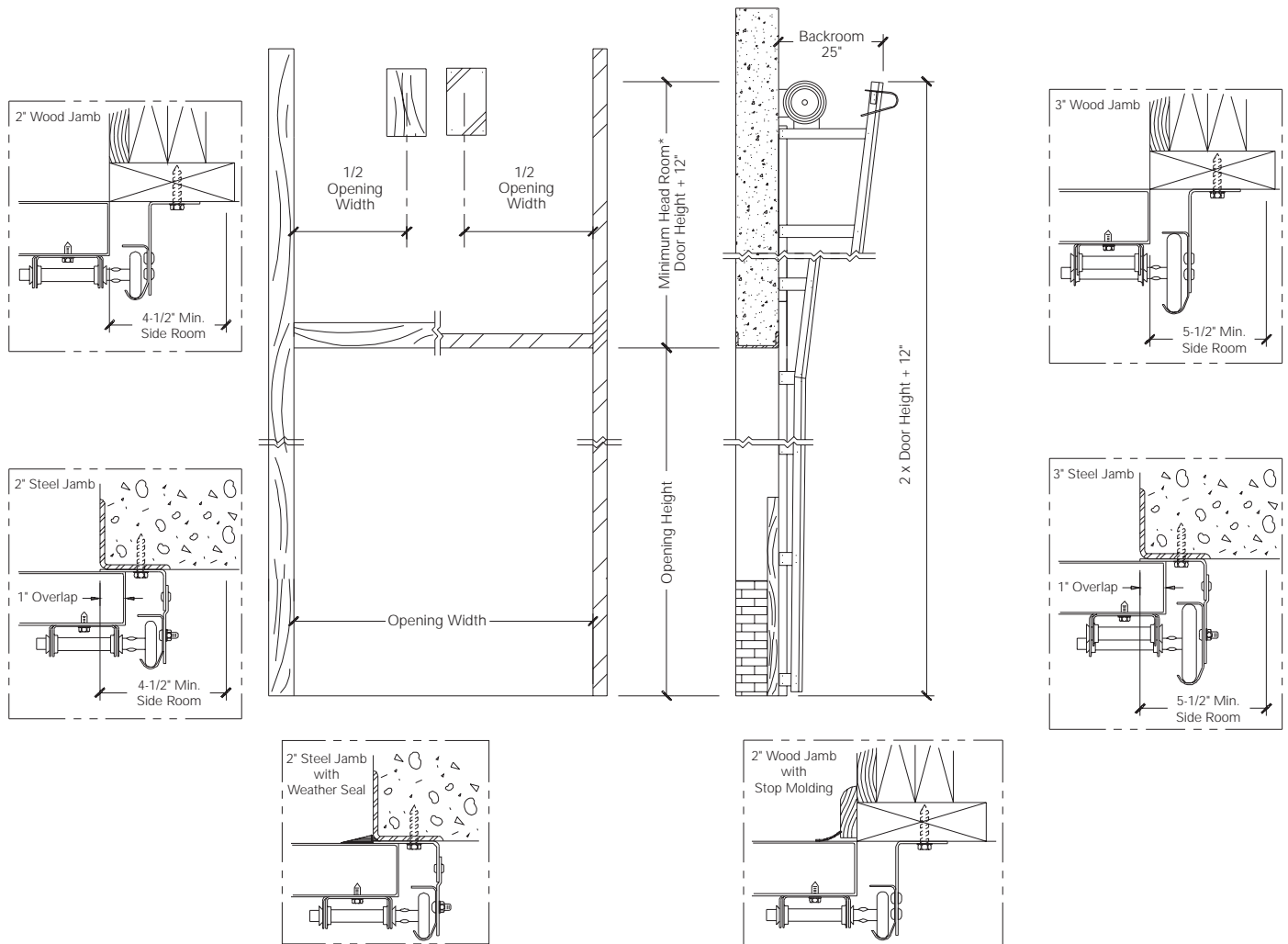

CLEARANCES

Track Size	Headroom	Backroom	Sideroom	Center Column	Approx. Spring Centerline	Chain Hoist	Jackshaft Operator
2" Track Ht+12"	Door Ht+12**	25"	4-1/2"	9"	Opening Ht x 2+6"	11-1/2"	Sideroom+30"
3" Track	Door Ht+12**	25"	5-1/2"	11"	Opening Ht x 2+6"	12"	Sideroom+30"

*Straight incline full vertical requires 12" additional headroom.

